

Lease Property Number	Lease ID	Contract Number	Business Name	Lease Property Number	Lease ID	Contract Number	Business Name	Lease Property Number	Lease ID	Contract Number	Business Name	Lease Property Number	Lease ID	Contract Number	Business Name
LP-001	50180	08388	Alaska Iron Works, Inc.	LP-008	5473		J&V Rentals (Terminated)	LP-072	413	07012	Geneco	LP-106	50056	07877	Pope & Katcher
LP-002	50226	08717	Spennard Builders Supply	LP-039	238	05531	Anchor Neighborhood Housing Services	LP-073	409	07025	Gress, Sash, and Door Supply	LP-106	50237	08758	Integrated Concepts & Research Corporation
LP-003	50232	8750	Flint Hills Resources Alaska, LLC	LP-040	342	05562	Alaska Construction Company	LP-074	459	07053	DiTomasso	LP-106	new	08881	Alaska Humanties Forum
LP-004	50231	08749	Flint Hills Resources Alaska, LLC	LP-041	244	05568	Stem, John & Lorna	LP-075	434	07065	Granbury, David E. and Jeanne A.	LP-107			ARRC - old Safety Klean
LP-006	50193	08624	AASJ General Contracting Corporation	LP-042	253	05611	York Steel Company, Inc.	LP-075	50070	07994	Uti Factory	LP-108	50277	08703	The Bridge, Inc.
LP-007	13	01879	Clasler Northwest, Inc.	LP-043	254	05612	Alaska Truck Center	LP-076	431	07115	Guardian Security Systems	LP-109	440	07045	Deniss Frenn and Arden Anderson
LP-008	20	02364	Craig Taylor Equipment	LP-044	259	05642	Inset Glass & Millwork	LP-077	409	07116	Time Centers	LP-110	416	07095	Bob Benson Trucking
LP-009	27	02505	Anchor Auto Detail	LP-045	50156	08397	Morgan, Bruce R. & Chels, Robin M.	LP-078	50175	08513	Accol Fire Systems, Inc.	LP-111	50243	08744	E. J. Bartalis
LP-010	28	02560	Five Star Partnershp	LP-046	276	05775	State of Alaska DNR	LP-079	50153	08205	MWME, LLC	LP-112	50213	08659	Sagepa Properties
LP-011	30	02579	Auto Electric Sales & Service	LP-047	277	05787	Tessor Gas Station	LP-080			Fleener Paper Co.	LP-113	454	07278	AAA Moving
LP-012	33	02652	Midnight Sun Tile	LP-048	50203	08631	Great Northwest Moving Company	LP-081	446	07204	Video City	LP-114	518	07815	Anchorage Fueling & Service Company
LP-013	36	02674	Alaska For-Wall Distributors	LP-049	50259	08549	Wingway Auto Centers	LP-082			Summit Paving	LP-115	50132	08262	Burnett, Robert B.
LP-014	40	02854	UCSC/ Motor Doctor	LP-050	307	06072	Alaska Crate & Pallet	LP-083	477	07241	Phus Corporation	LP-116	50189	08482	Suburban Propane, LP
LP-015	50124	08208	Cherter & Cherrier	LP-051	309	06091	BAK Properties	LP-084	50184	08203	Swan Bay Holdings, Inc.	LP-117			Walker Prodigy
LP-016	422	03189	Cherwon USA Products Company	LP-052	310	06119	Hickey, Patrick M.	LP-085	458	07266	CBS Equipment	LP-118	519	07815	Alaska Pipeline Company
LP-017	50186	08686	Pine Road Properties, LLC	LP-053	311	06127	SAM Small Engine Repair	LP-086	516	07268	Municipality of Anchorage, Cottages	LP-119	534	07834	Municipality of Anchorage, Substation
LP-018	50279	08624	L.H. Construction, Inc.	LP-054	329	06362	Municipality of Anchorage, Greenbelt	LP-087	50199	08913	UJJI LLC	LP-120	525	07884	Kapp LLC
LP-019	114	04392	Tessoro Alaska Company	LP-055	331	06362	CVJ Wells	LP-088			Nana Management	LP-121			Anchor Industrial & Construction Supply
LP-020	50219	08883	Wholesale Distributors	LP-056	335	06392	R.J.H. Inc.	LP-089	50241	08549	Wells, C.V., Jr.	LP-122	50005	07875	Inc
LP-021	50208	08638	Shig Creek Constructors, LLC	LP-057	336	06393	Shanard Office Building, LLC	LP-090	488	07404	Ashley Home Stores	LP-123	50215	08651	Underfoot Enterprises
LP-022	125	04885	Municipality of Anchorage, Municipal Light & Power	LP-058	342	06426	Inv-Vestment Associates of Alaska	LP-091	50273	08812	Newbery Alaska	LP-124			Alma Corporation
LP-023	127	04596	Denial Federal Credit Union	LP-059	344	06434	Municipality of Anchorage, Tideways	LP-092	50162	08364	The Orem Corporation (ANCH)	LP-125	50072	07733	L&L Cars
LP-024	50208	08792	1940 Post Road, LLC	LP-060	50152	08423	North Star Terminal and Stevedore Company, Inc.	LP-093	507	07421	M.I. LLC	LP-126			Review Parking Lot
LP-025	146	04872	Cherwon USA Products Company	LP-061	353	06488	Municipality of Anchorage, City Dock	LP-094	500	07475	Alaska Basic Industries, Inc.	LP-127	50015	07745	Post Road Co-Tenancy
LP-026	151	04895	Alaska Teamster Employee Service	LP-062	355	06509	Anchorage Cold Storage	LP-095	50272	08819	Bayview Properties, LLC	LP-128	50019	07199	Seamless Factory
LP-027	161	04896	Cherwon USA Products Company	LP-063	356	06507	Denial Leasing Company	LP-096	50181	08553	Alaska Fiber Star, LLC	LP-129	50033	07831	Statwood Door & Glass
LP-028	165	05009	State of Alaska DMR	LP-064			Anchorage Cold Storage	LP-097	50249	08677	Lighthouse Christian Fellowship	LP-130	50262	08814	Platchem Supply & Consulting, Inc.
LP-029	151	04895	Alaska Teamster Employee Service	LP-065	358	06513	Four Alaska, LLC	LP-098	50159	08457	H&I Airport LLC	LP-131	50056	07980	IFR, LLC
LP-030	173	05075	Denial Transportation Corporation	LP-066	359	06514	Westours Motorcoaches	LP-099	50302	08921	Emulsion Products Company	LP-132	50038	07891	Whitney Road Warehouse, LLC
LP-031	50134	08273	JEI LLC & 200 First Road, LLC	LP-067	362	06545	Phonics Tours	LP-100	50203	08292	Signature Flight Support (ROW)	LP-133	50053	07892	Alaska Travel Adventures, Inc.
LP-032	50292	08475	Eyak Trucking / Allison's	LP-068	362	06545	Susha Investment Company, Inc.	LP-101	216	05423	Swan Bay Holdings, Inc.	LP-134	50049	05005	7904/7905/HV Alaska, LLC
LP-033	50218	08681	JEI LLC and Hiler LLC	LP-069	362	06545	Spennard Builders Supply	LP-102	419	05468	Signature Flight Support	LP-135	50073	08038	Bravo Properties, LLC
LP-034	206	05314	Jerry P. White	LP-070	373	06650	Premier Industries, Inc.	LP-103	419	05468	Line Star ROW	LP-136	50076	08024	Hotel Construction & Engineering
LP-035	212	05414	Janssen Contracting Company	LP-071	385	06788	Dean's Automotive	LP-104	50034	08792	Flint Hills Resources Alaska, LLC	LP-137	50119	08304	Alaska West Express, Inc.
LP-036	2014	08361	Longstaff, Inc.	LP-072	401	06869	Soldan Era Investment Corporation	LP-105	50054	08786	Satum Construction, Inc.	LP-138			Tessoro Pipeline ROW
LP-037	225	05469	21st Century Trust	LP-073	402	06874	BDK Partnership	LP-107	402	06874	BDK Partnership	LP-139			Suburban Propane

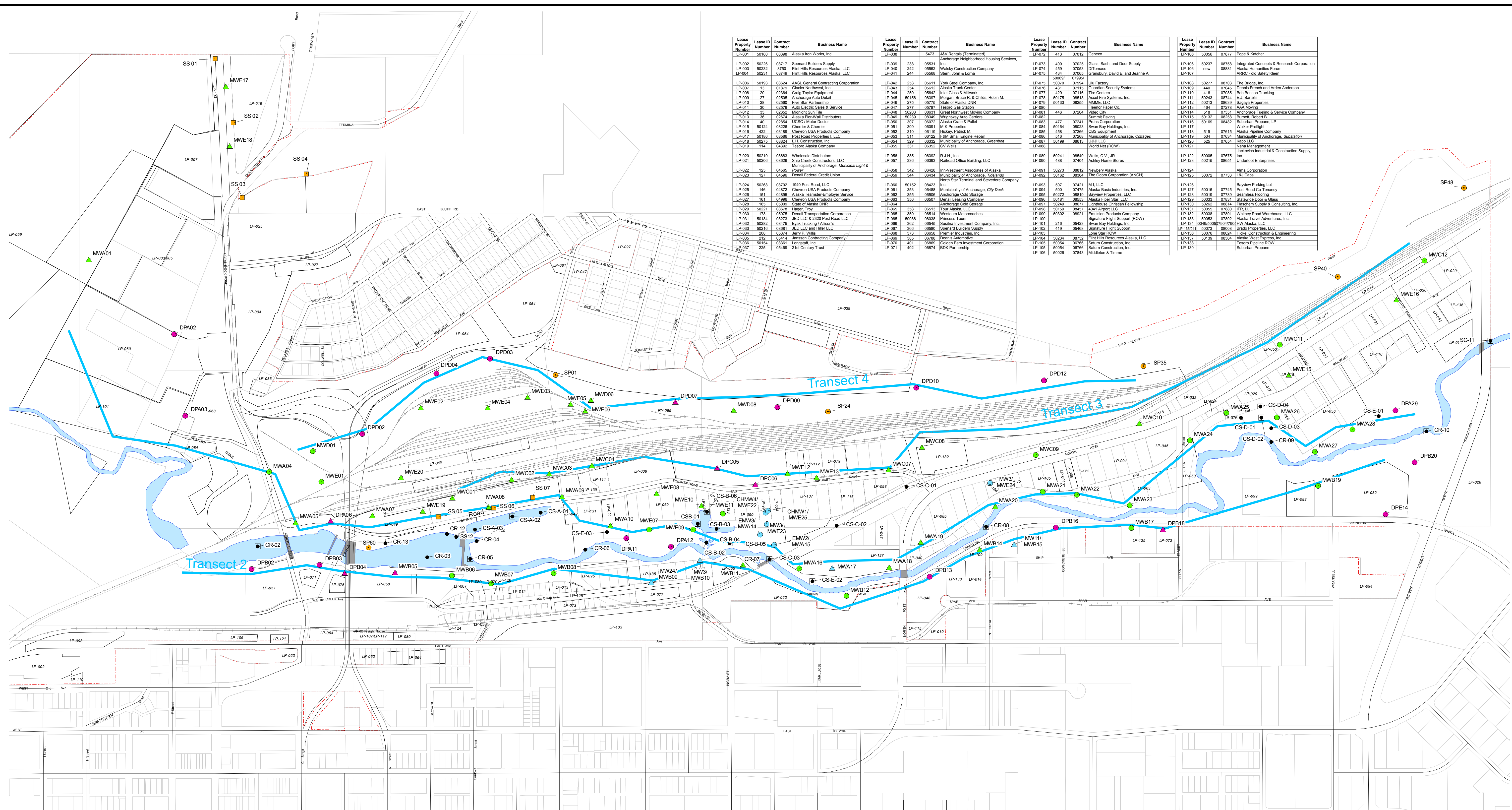

Legend	
	ARRC Property Boundary
	RI Work Plan Groundwater Transects
	Surface Soil Sample
	Seep
	Ship Creek Sampling
	Sediment Sample
	Sediment and Surface Water Samples
	Conventional Wells (Installed using Hollow Stem Auger Techniques) -Schedule 40 PVC screen and riser -0.020 inch slot screen
	New Well - Flush Mount
	New Well - Stick-up
	Drive Point Wells (Installed using Direct Push Techniques) -Steel riser -0.015 inch slot stainless steel screen
	Drive Point - Flush Mount
	Drive Point - Stick-up
	Existing Wells (Installation technique and completion data unspecified)
	Existing Well - Flush Mount
	Existing Well - Stick-up



**REMEDIAL INVESTIGATION/FEASIBILITY  
STUDY WORK PLAN ADDENDUM**

ALASKA RAILROAD CORPORATION, ANCHORAGE, ALASKA

Date: 06/16/06      Dwn By: RLB/ftc

**RI 2005  
SAMPLING LOCATIONS**

**FIGURE 1-1**