

NOTES

- 1) HORIZONTAL AND VERTICAL DATUM IS ALASKA STATE PLANE
- 2) GEIOD12B PER SURFBASE CONTROL
- 3) TOPOGRAHIC INFORMATION AND IMAGERY GATHERED USING TRADITIONAL SURVEYING AND MAY 2019 APN UAV DATA PROCESSED USING AGISOFT PHOTOSCAN PROFESSIONAL
- 3) CENTERLINE AND STATIONING PER ARRC CAD

SHEET INDEX

- 1) EXISTING SITE CONDITIONS
- 2-5) EXISTING SITE CROSS SECTIONS
- 6-8) RETAINING WALL PLAN & DETAILS
- 8-11) OVERHANG AREA PLAN & DETAILS



CONTROL POINT LIST

Point	Northing	Easting	Elevation	Description
1	2442166.15	1811054.89	353.00	SET REBAR YPC 12039
6	2442369.30	1810996.70	344.73	SET 60D
13	2441958.92	1811059.59	358.58	SET PK
15	2441839.10	1811124.87	359.79	SET REBAR YPC 12039
48	2442362.50	1811013.77	349.93	SET 60D
55	2442098.31	1811042.59	355.47	SET PK
454	2442530.93	1811007.03	345.91	FND YPC-RBR 8201
455	2442245.13	1811053.32	353.33	FND YPC-RBR 8201
456	2441907.56	1811093.19	359.71	FND YPC-RBR 8201

LEGEND

- ➔ CONTROL POINT, SEE POINT LIST
- 2% CONTOURS, PER UNFILTERED MAY 2019 UAV DATA



NO.	REVISIONS	DATE	BY

ALL POINTS NORTH	CLIENT	ALASKA RAILROAD	JOB NUMBER	19-04	
	PROJECT	MP 52.16 - 52.40 SAFETY IMPROVEMENTS	DATE	6/25/2019	
SHEET TITLE	EXISTING SITE CONDITIONS			SHEET NO.	1 OF 13



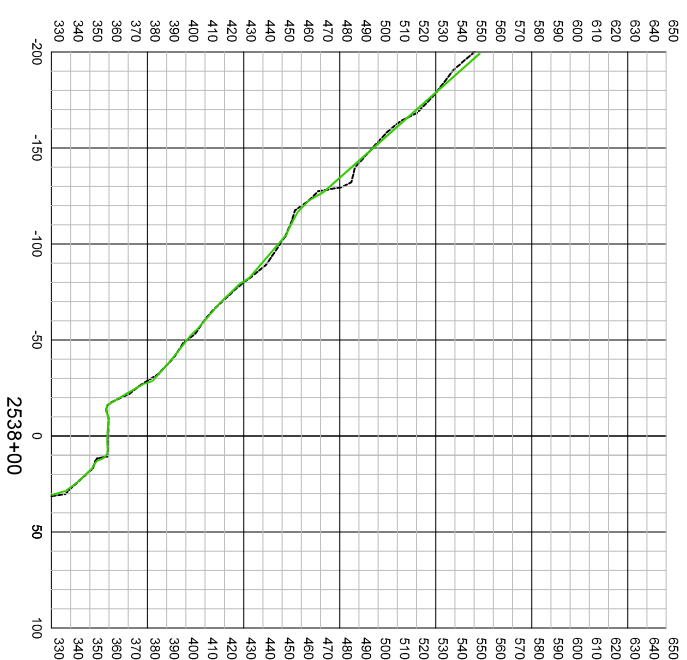
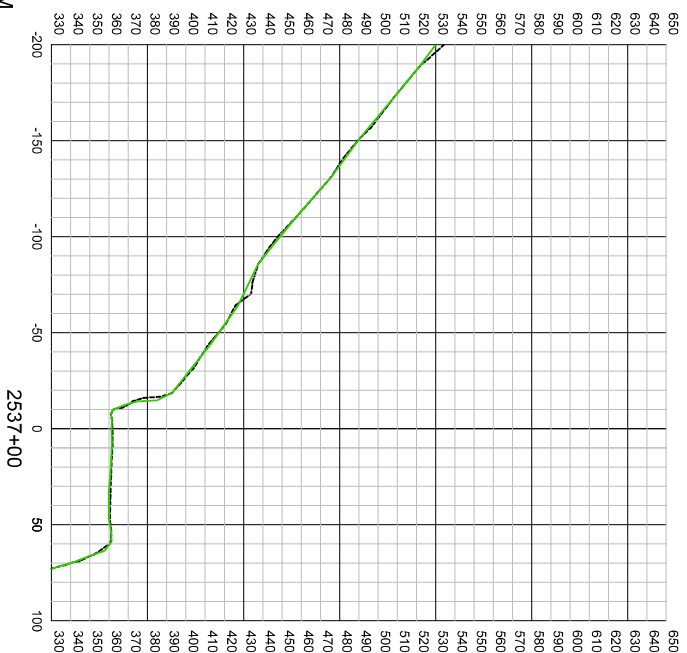
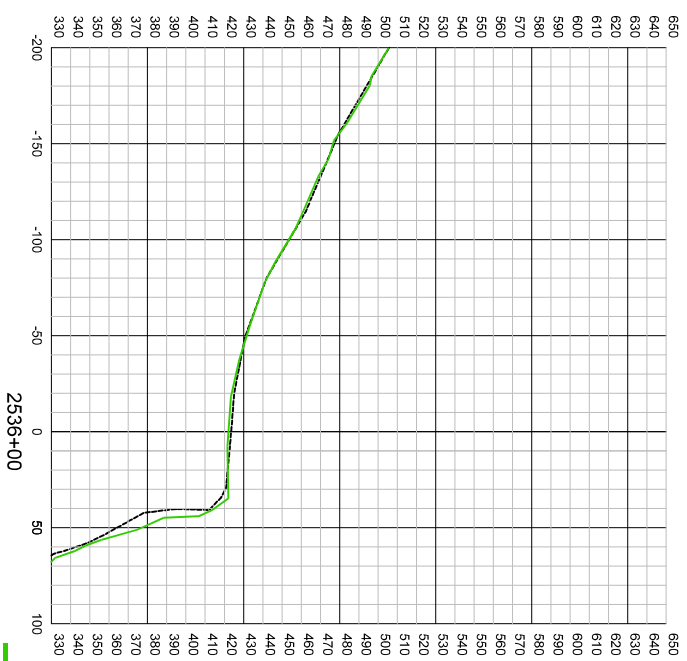
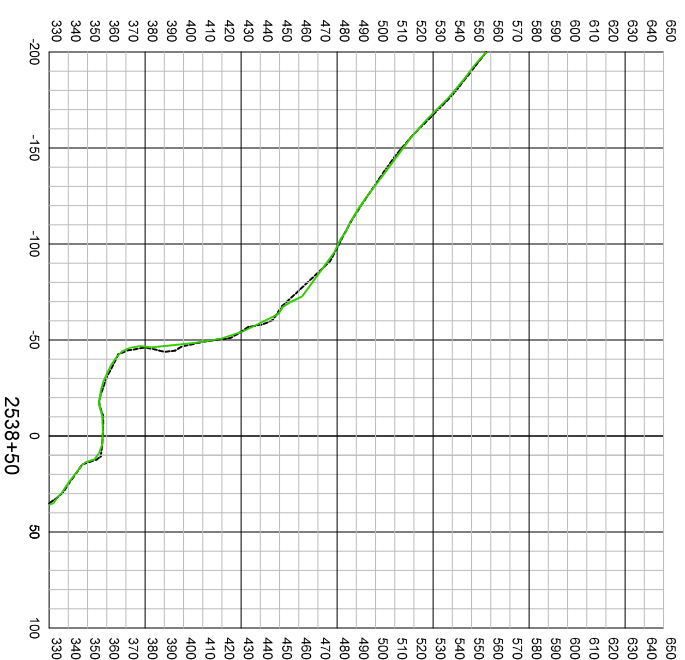
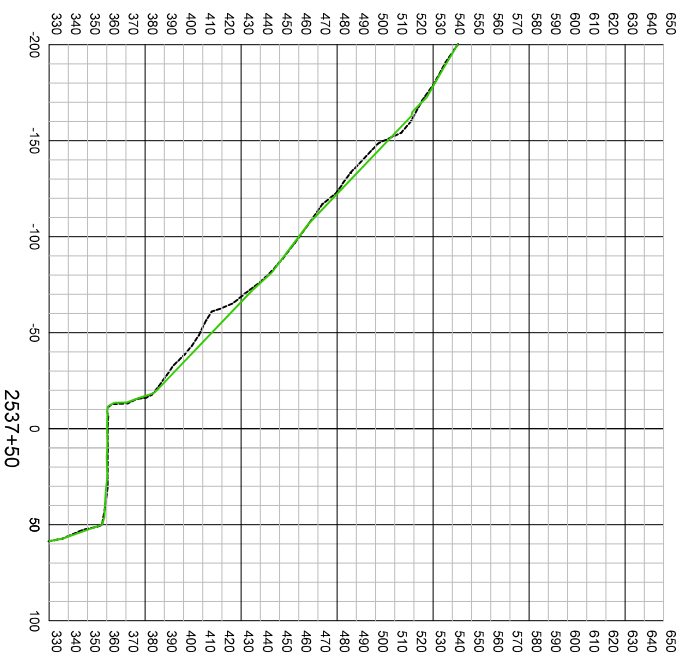
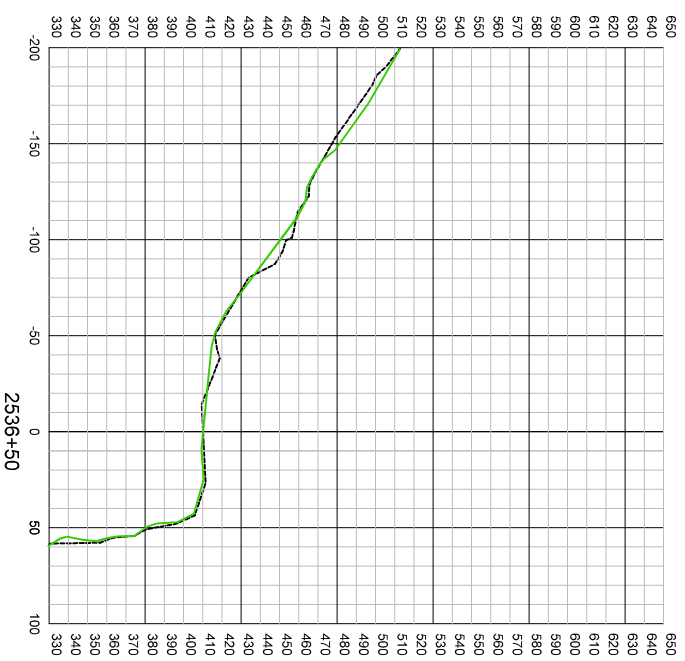

——— MAY 2019 DRONE DSM
- - - - - NOV. 2018 DRONE DSM

STA. 2538+00 - 2539+00: SEE SHEETS 6 & 7 FOR RETAINING WALL DETAIL

		ALL POINTS NORTH			
CLIENT	ALASKA RAILROAD	JOB NUMBER	19-04	DATE	6/25/2019
PROJECT	MP 52.16 - 52.40 SAFETY IMPROVEMENTS	SHEET TITLE	EXISTING SITE CONDITIONS	SHEET NO.	2 OF 13
SCALE	1" = 30 FEET H & V				
REVISIONS					
DATE					
BY					

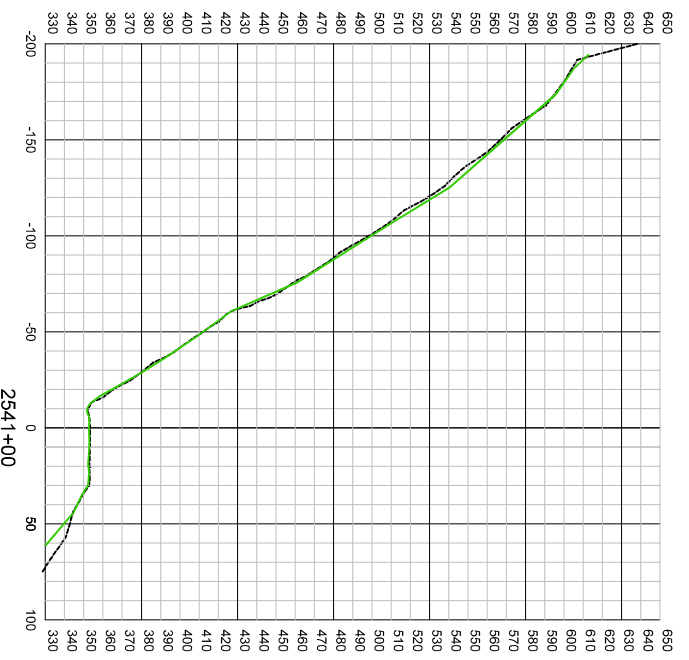
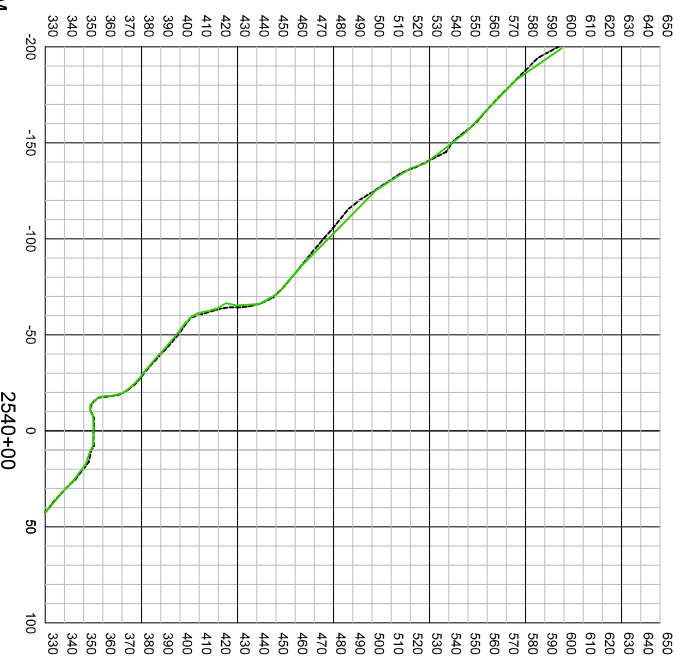
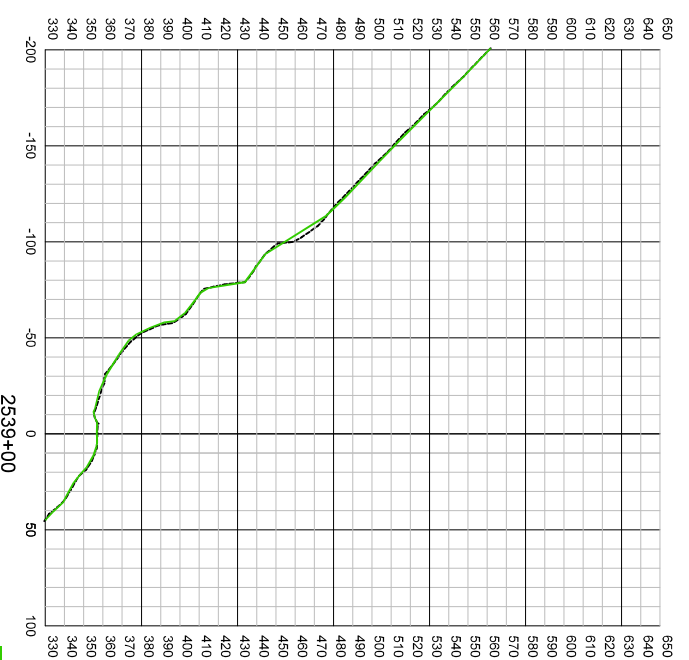
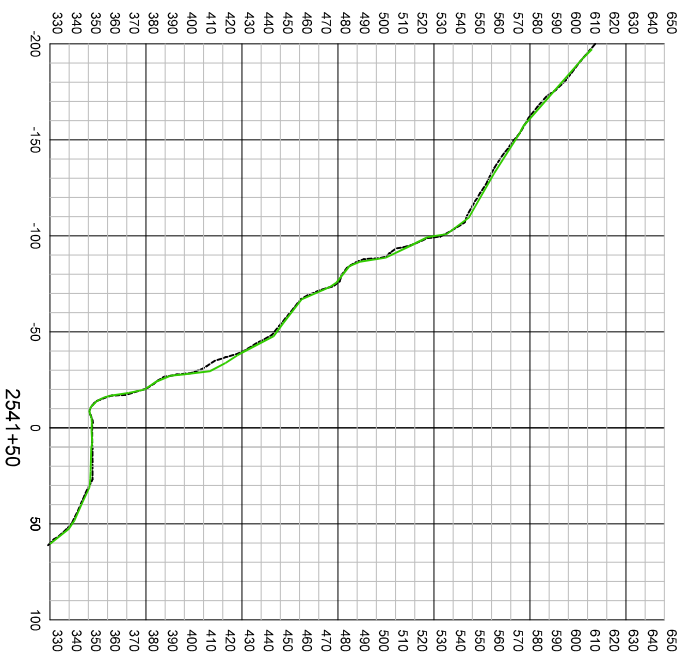
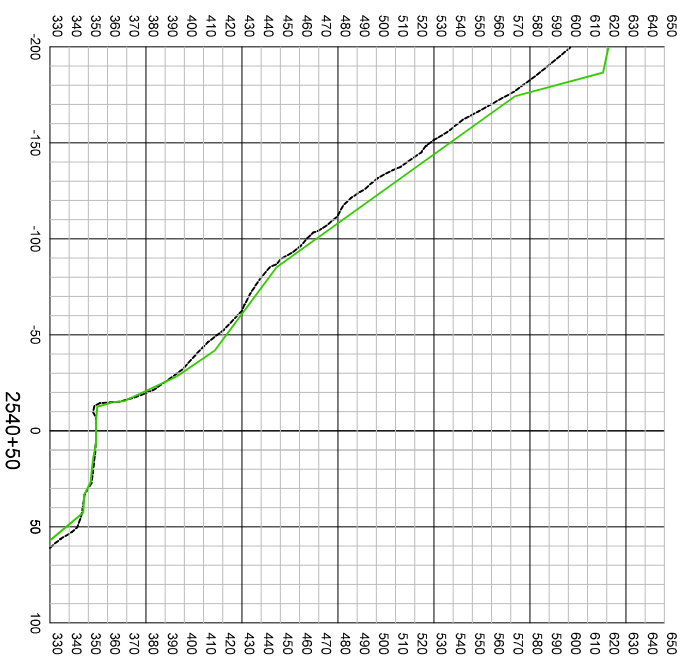
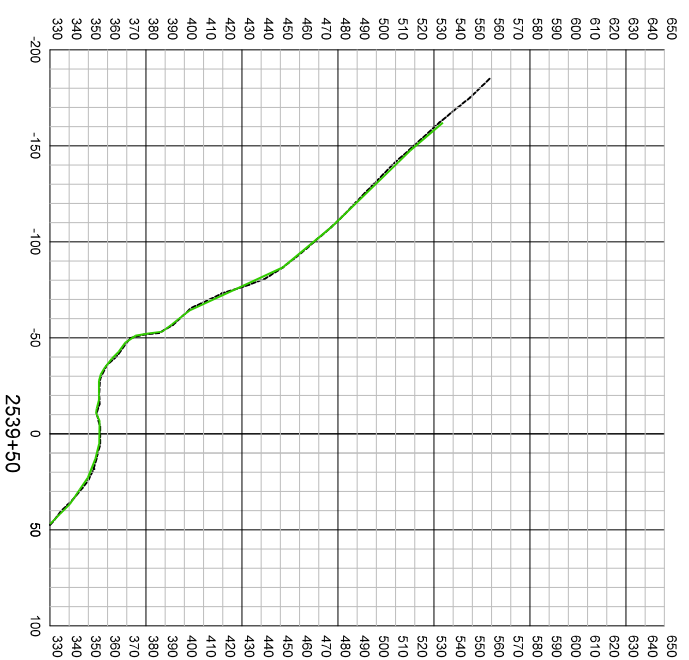

——— MAY 2019 DRONE DSM
- - - - - NOV. 2018 DRONE DSM

NO.	REVISIONS	DATE	BY

ALL POINTS NORTH
 CLIENT: ALASKA RAILROAD
 PROJECT: MP 52.16 - 52.40 SAFETY IMPROVEMENTS
 SHEET TITLE: EXISTING SITE CONDITIONS
 JOB NUMBER: 19-04

SCALE: 1" = 30 FEET H & V
 DATE: 6/25/2019
 SHEET NO: 3 OF 13

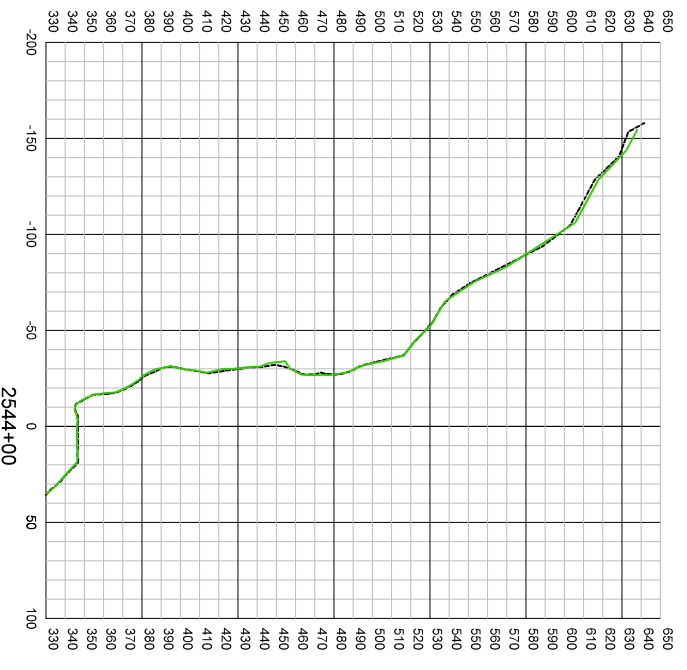
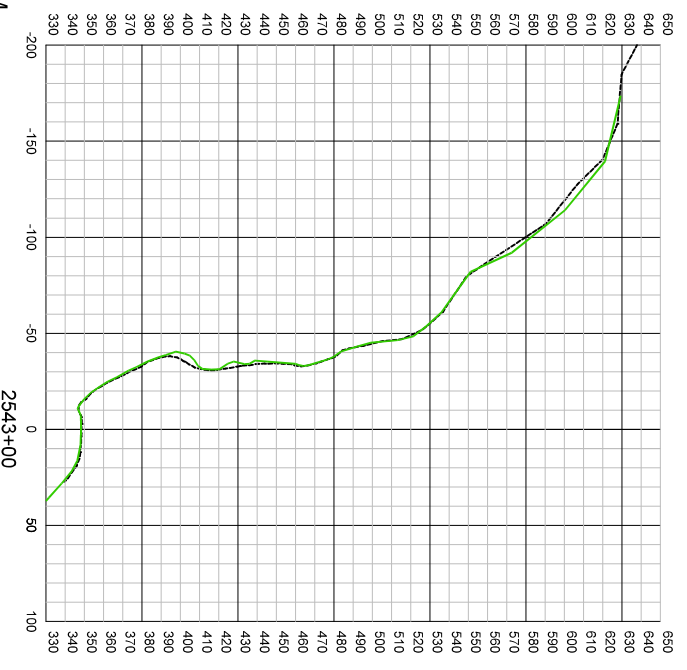
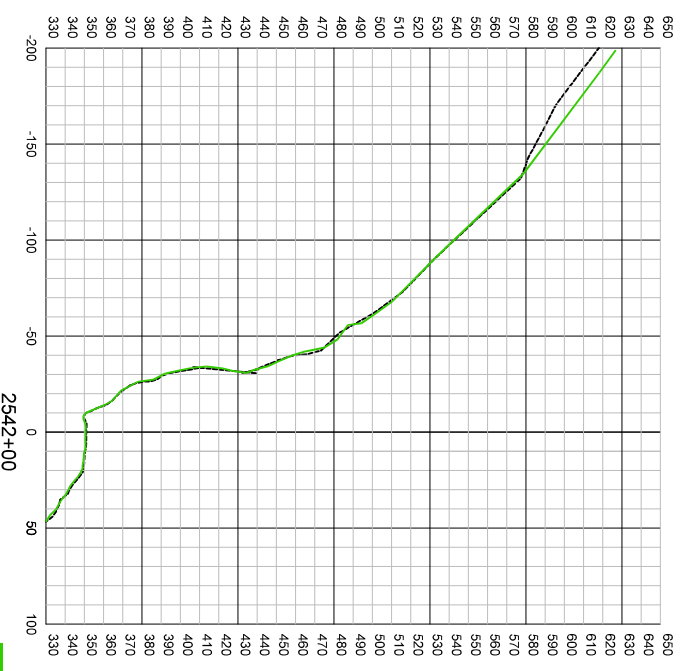
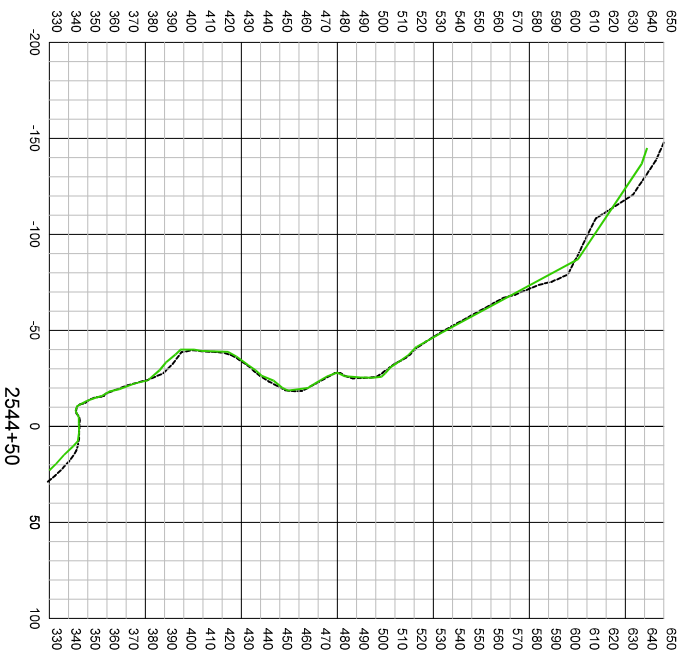
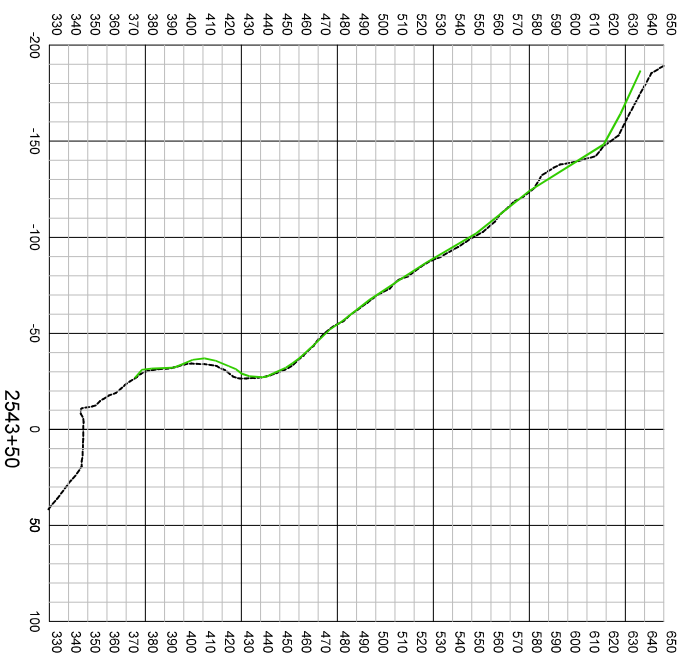
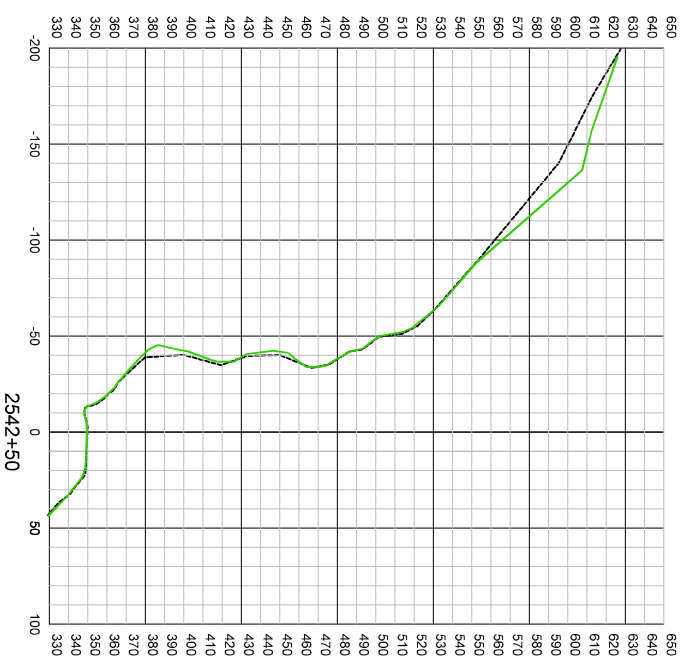

——— MAY 2019 DRONE DSM
- - - - - NOV. 2018 DRONE DSM

NO.	REVISIONS	DATE	BY

ALL POINTS NORTH
 CLIENT: ALASKA RAILROAD
 PROJECT: MP 52.16 - 52.40 SAFETY IMPROVEMENTS
 SHEET TITLE: EXISTING SITE CONDITIONS
 JOB NUMBER: 19-04

SCALE	1" = 30 FEET H & V
DATE	6/25/2019
SHEET NO.	4 OF 13

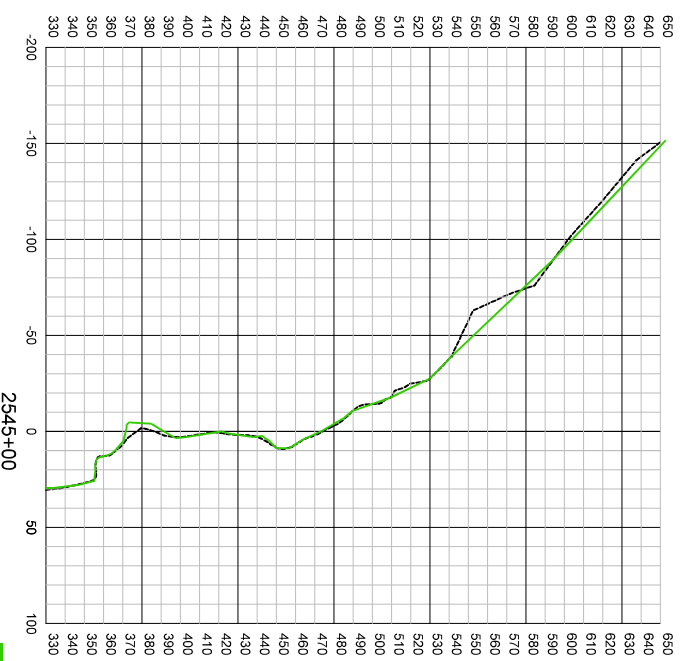
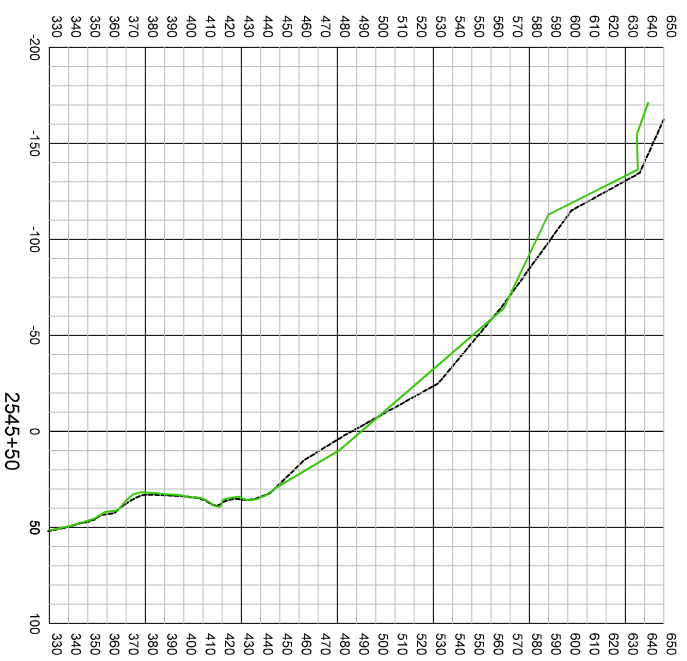

——— MAY 2019 DRONE DSM
 - - - - - NOV. 2018 DRONE DSM

SCALE		1" = 30 FEET H & V	
DATE	6/25/2019	JOB NUMBER	19-04
SHEET NO	5 OF 13	CLIENT	ALASKA RAILROAD
PROJECT		MP 52.16 - 52.40 SAFETY IMPROVEMENTS	
SHEET TITLE		EXISTING SITE CONDITIONS	
BY		DATE	
REVISIONS			
SW			



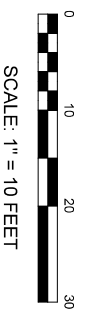
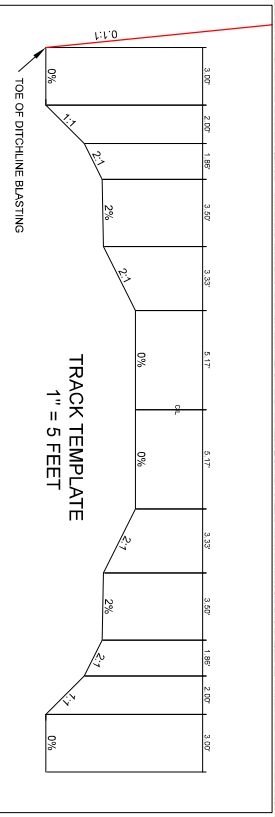
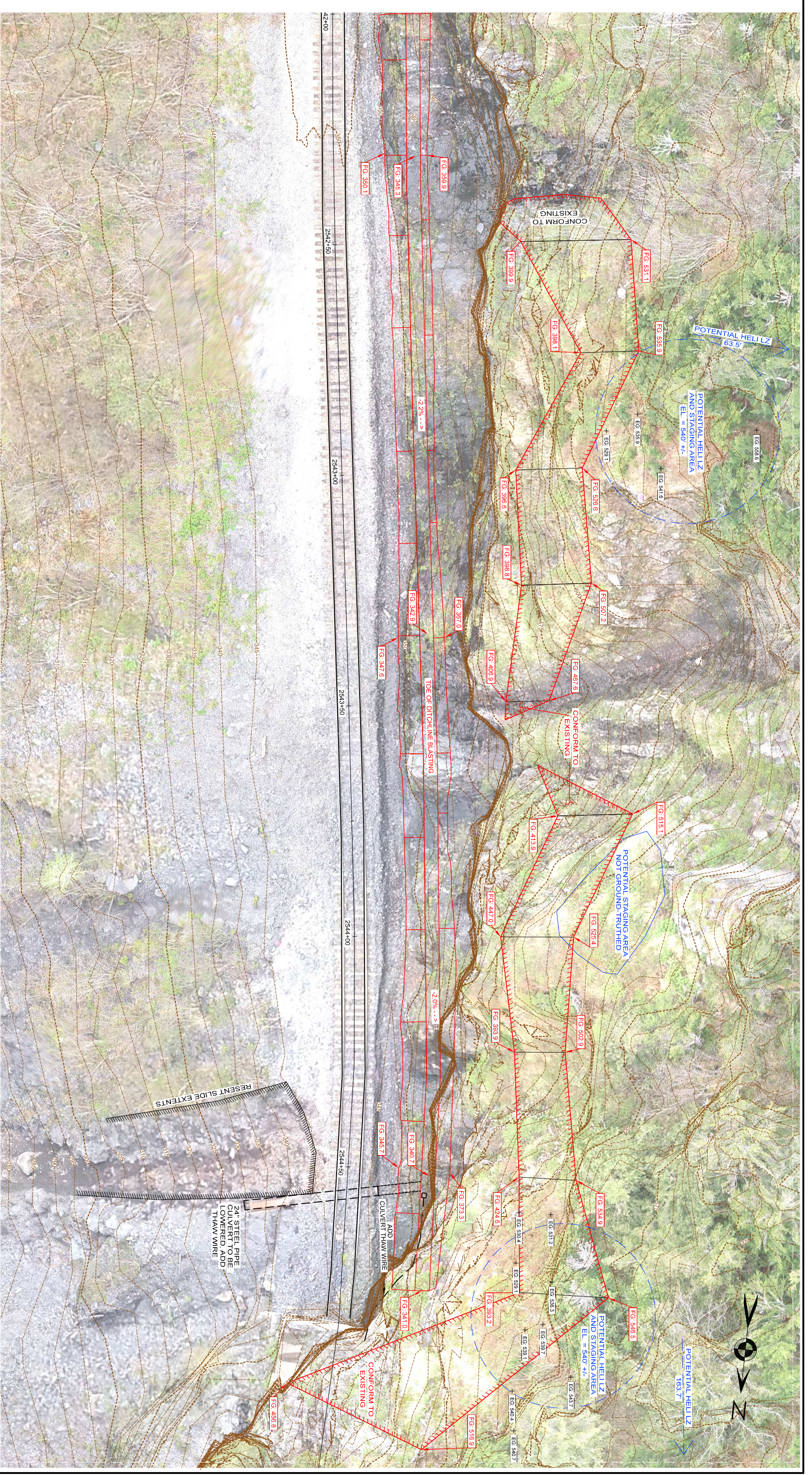

NO.	DATE	BY	REVISIONS

ALL POINTS NORTH

CLIENT	ALASKA RAILROAD	JOB NUMBER	19-04
PROJECT	MP 52.16 - 52.40 SAFETY IMPROVEMENTS	DATE	6/25/2019
SHEET TITLE	OVERHANG AREA PLAN & DETAILS	SHEET NO.	9 OF 13

SCALE 1"=10 FEET

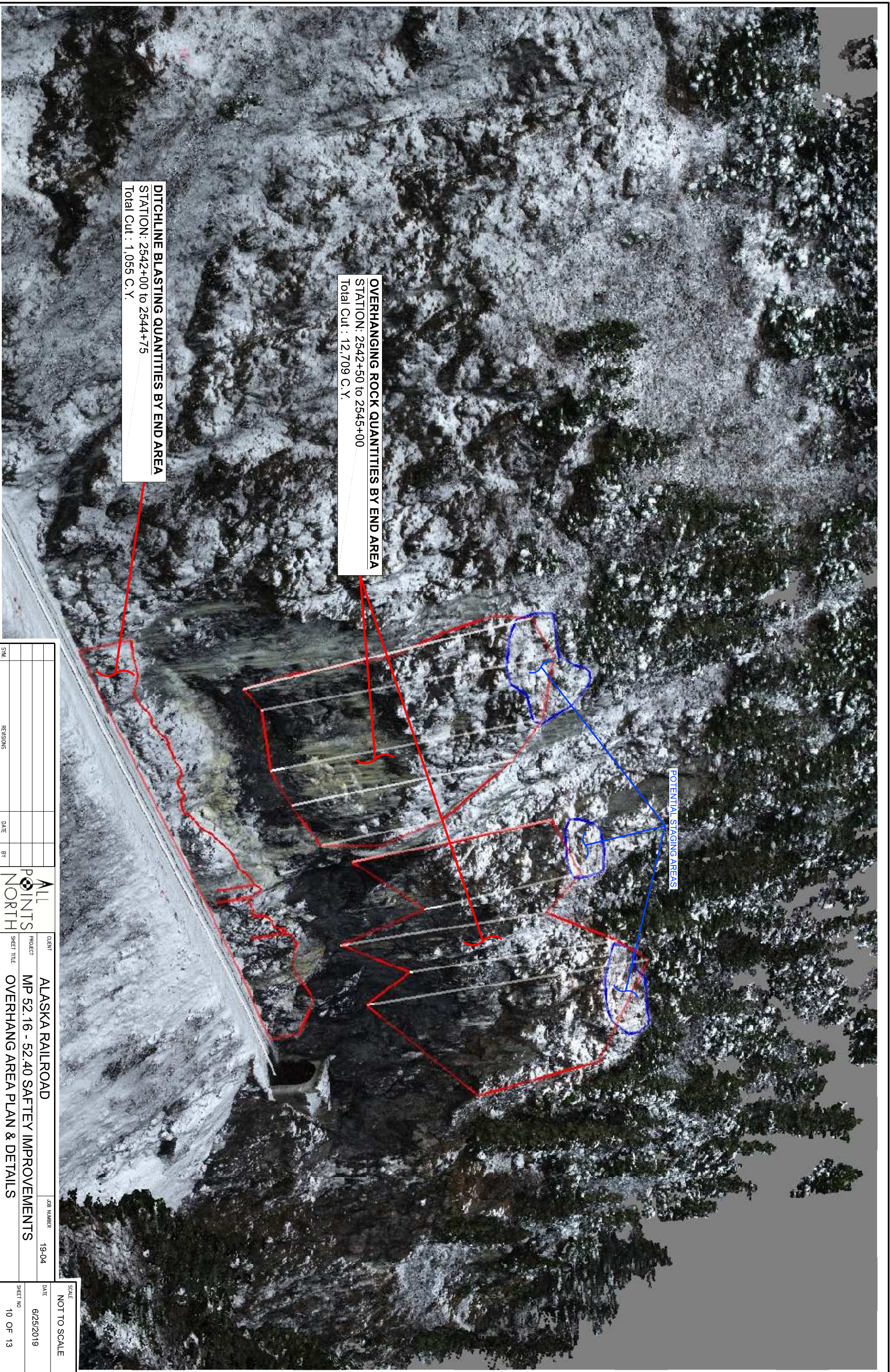

POTENTIAL STAGING AREAS

OVERHANGING ROCK QUANTITIES BY END AREA
 STATION: 2542+50 to 2545+00
 Total Cut : 12,709 C.Y.

DITCHLINE BLASTING QUANTITIES BY END AREA
 STATION: 2542+00 to 2544+75
 Total Cut : 1,055 C.Y.

NO.	REVISIONS	DATE	BY

	CLIENT	ALASKA RAILROAD
	PROJECT	MP 52.16 - 52.40 SAFETY IMPROVEMENTS
SHEET TITLE	OVERHANG AREA PLAN & DETAILS	
JOB NUMBER	19-04	DATE
DATE	6/25/2019	SHEET NO
SHEET NO	10 OF 13	SCALE

SCALE
NOT TO SCALE

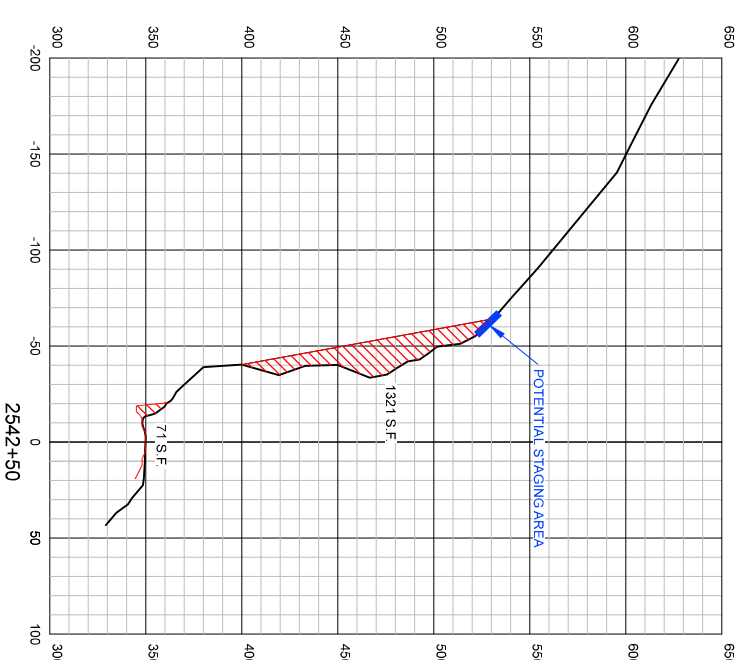
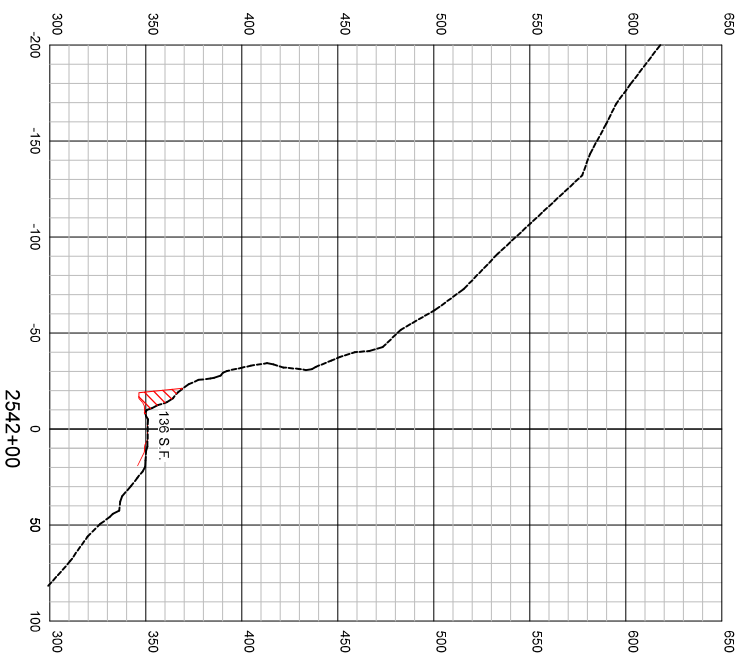
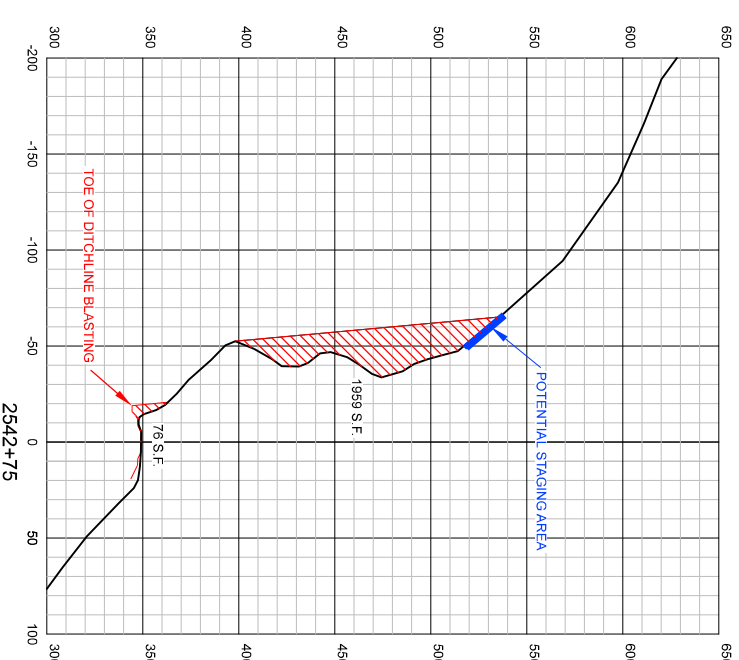
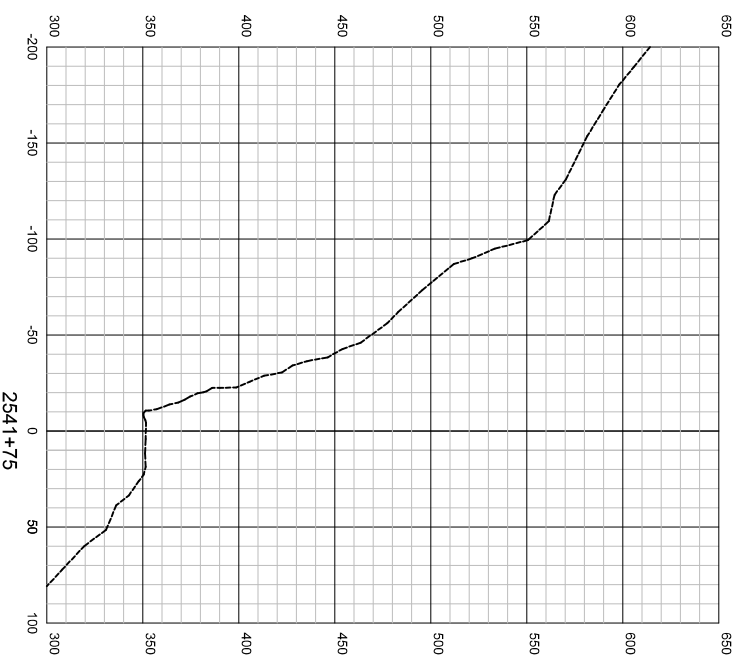

NO.	REVISIONS	DATE	BY

ALASKA RAILROAD
 CLIENT
MP 52.16 - 52.40 SAFETY IMPROVEMENTS
 PROJECT
OVERHANG AREA PLAN & DETAILS
 SHEET TITLE
 JOB NUMBER 19-04
 DATE 6/25/2019
 SHEET NO 11 OF 13

SCALE 1" = 50 FEET H & V
 DATE 6/25/2019
 SHEET NO 11 OF 13

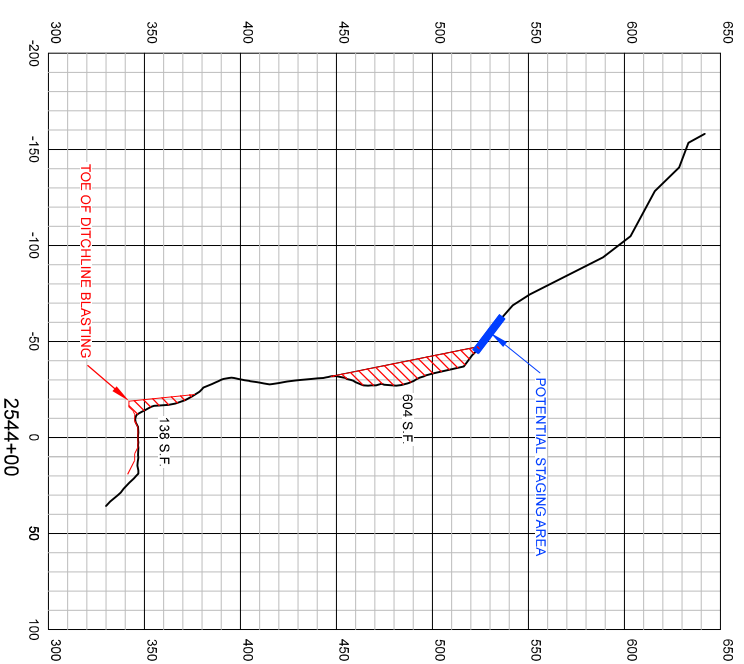
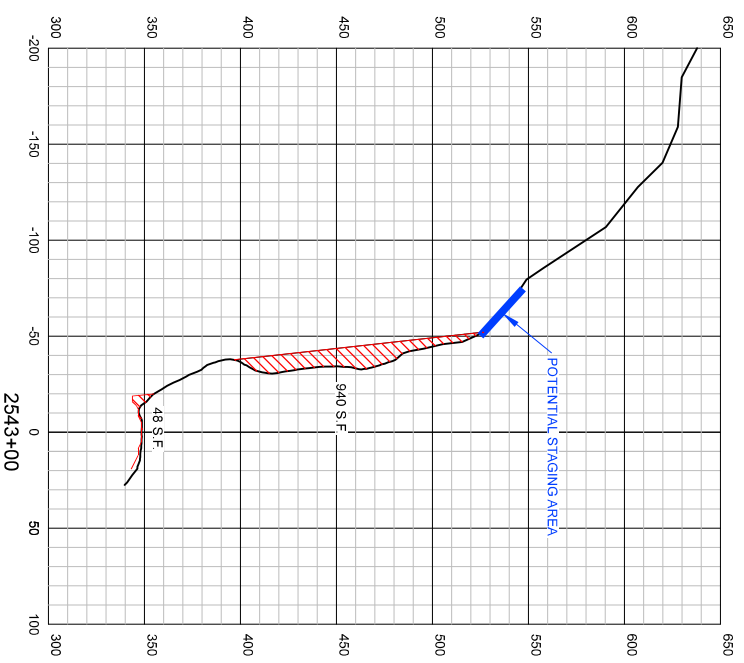
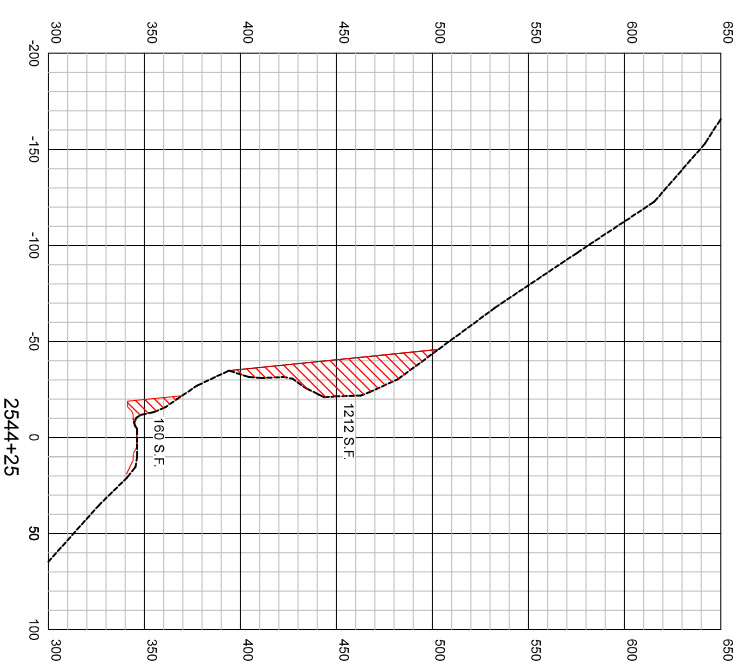
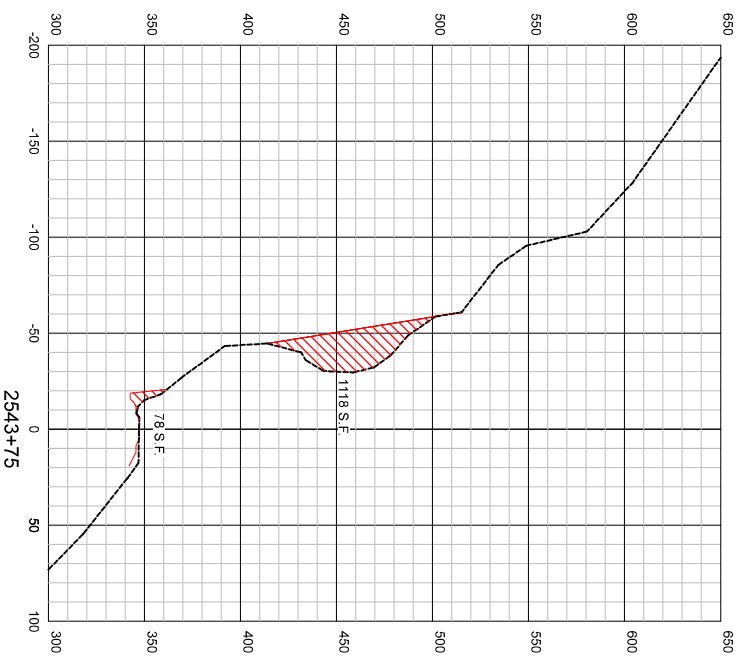
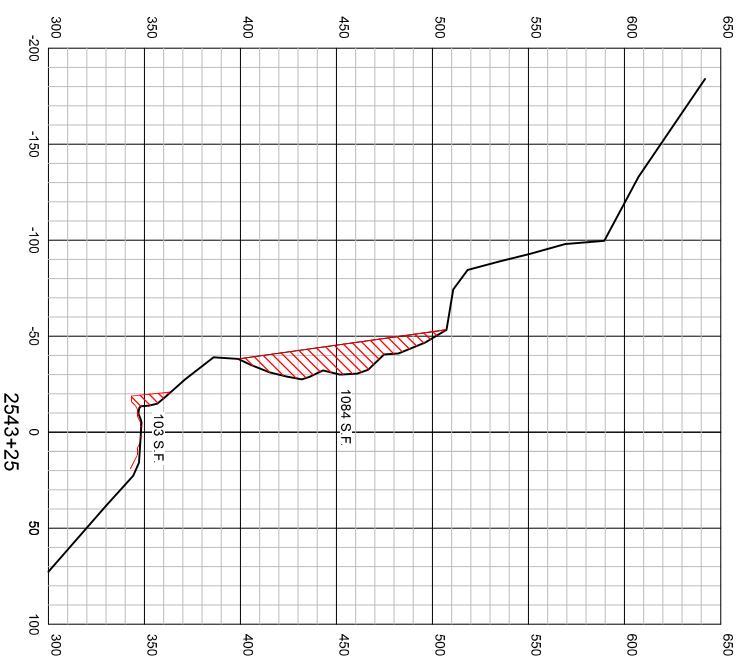

CLIENT	ALASKA RAILROAD
PROJECT	MP 52.16 - 52.40 SAFETY IMPROVEMENTS
SHEET TITLE	OVERHANG AREA PLAN & DETAILS
JOB NUMBER	19-04

DATE	BY
REVISIONS	

SCALE	1" = 50 FEET H & V
DATE	6/25/2019
SHEET NO.	12 OF 13



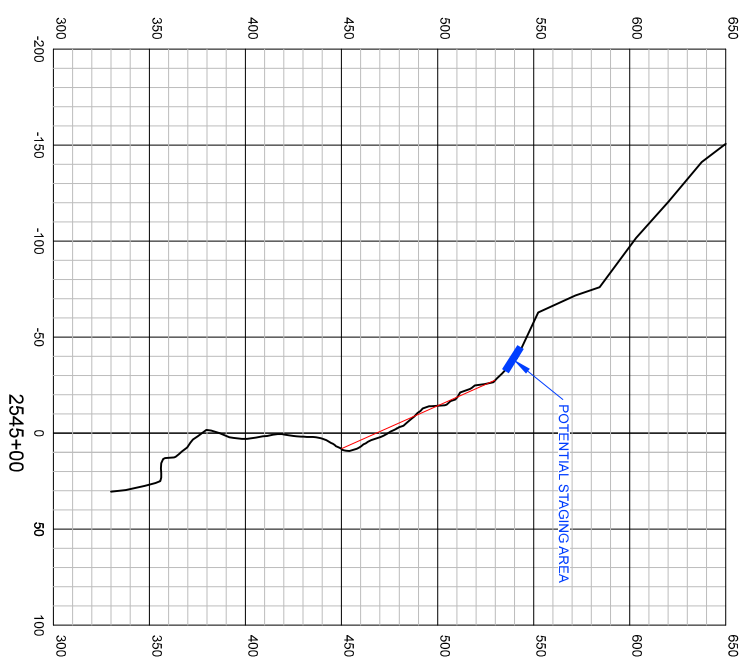
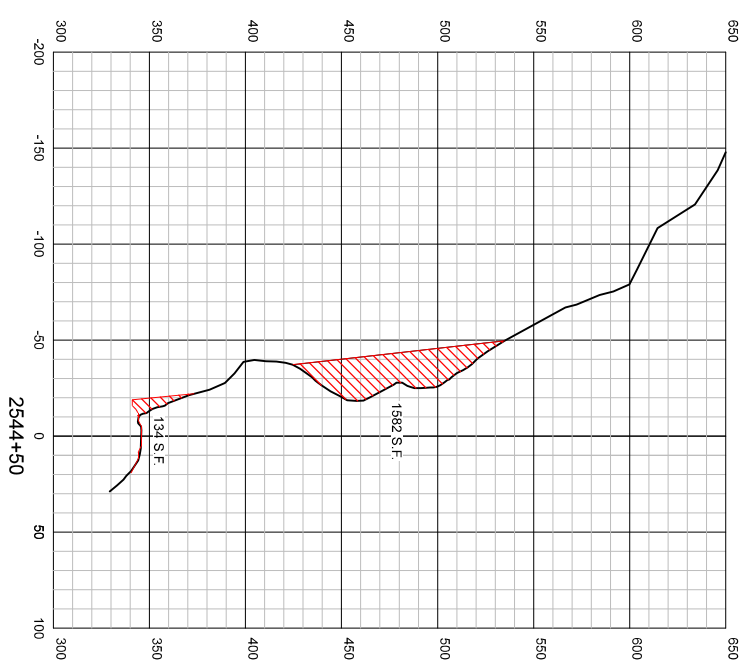
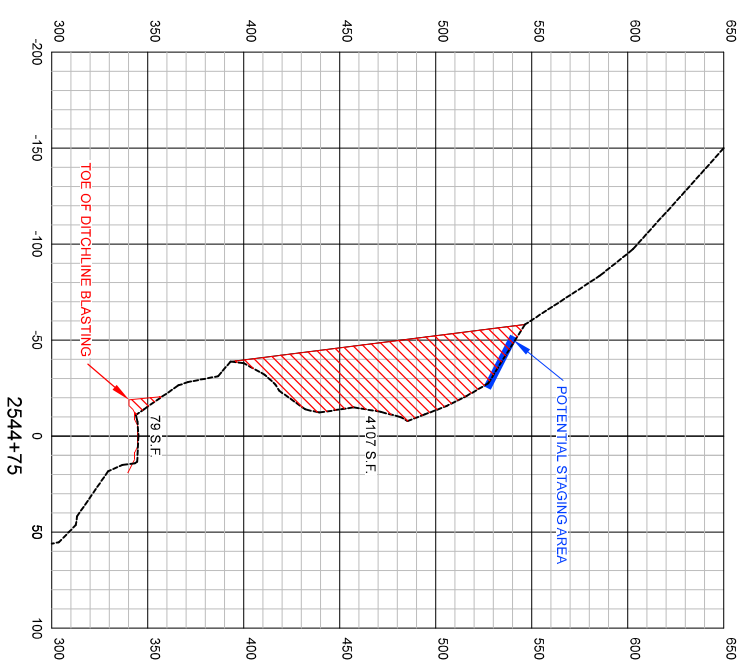

SCALE	1" = 50 FEET H & V
DATE	6/25/2019
SHEET NO	13 OF 13
CLIENT	ALASKA RAILROAD
PROJECT	MP 52.16 - 52.40 SAFETY IMPROVEMENTS
SHEET TITLE	OVERHANG AREA PLAN & DETAILS
JOB NUMBER	19-04
DATE	
BY	
REVISIONS	
SYMBOL	

