



Alaska Railroad Corporation
327 W. Ship Creek Ave.
Anchorage, AK 99501

June 18, 2020

Addendum 1
Invitation to Bid # 20-26-208267
Whittier Yard: Subgrade Drainage Improvements

Addendum number 1 is issued for Questions, Revised Appendix I : Cost Schedule, and the scheduling of a site visit.

The Closing Date for this ITB has not changed.
Bids will be received until Tuesday June 30, 2020 @ 3:00 PM Alaska time.

A Pre-Bid Site visit will held **on Tuesday June 23rd** at 11:00 am. Those planning on attending shall bring PPE, including but not limited to: Hard Hat, Safety Glasses, and Steel Toed Boots. Please dress appropriately for weather. In observance with the COVID-19 pandemic, parties are required to adhere to all federal, local, and state regulations currently in place. Contractors are advised to verify the Whittier Tunnel schedule access @ whittieralaska.gov/tunnel/

A new Plan Set will be issued on Monday June 22, to reflect the changes and updated material quantities.

Questions:

1. Will the ARRC provide gondola railcars at no cost to the contractor for demolition materials and will the owner be responsible for disposing of those demolition materials after the contractor has loaded the materials into said rail cars?
 - a. **The Contractor will be responsible for all costs associated with the disposal of all waste generated in support of the project. For availability and pricing of gondola cars, please contact Mrs. Michelle Renfrew, Senior Account Manager at 907.265.2258 and RenfrewM@akrr.com.**
2. Cost schedule calls for 1 Each 48" Precast Manhole. What SDMH is the 48" Precast Manhole? Will the ARRC provide a detail for this structure or will ARRC expect the manufacturer to do so.
 - a. **The 48"Ø SDMH is to be placed at ≈Sta. 67+06, 136' RT; see Sheet 3 of 11 and Note 1. The structure itself should be similar to the Municipality of Anchorage (Muni)'s Type 1 Storm Drain Manhole (SDMH) Detail 55-4 with a grate and solid lid similar to the Muni's Detail 55-7. The aforementioned details will be provided and incorporated into the Contract Documents. As the structure is outside the operational driving surface, the structure does not need to be designed to support the design vehicle provided in the Contract Documents. The fabricator will still be required to submit shop drawings for approval by the Owner.**

3. Are all the structures to be installed with grated lids?
 - a. No. An installation schedule will be added to Sheet 3 of 11 indicating the structure's size, identification number, and lid type (solid or grate).

4. Why are the quantities for additive alternate bid items A2 and A3 far less than the associated area calls for? This could lead to unbalanced unit prices if the owner decides to install quantities that the area calls for.
 - a. The cost schedule was updated based on the quantities shown on Sheet 9 of 11. Please use the revised Cost Schedule in its entirety in your bid package.

5. Will the ARRC entertain changing the completion date or providing a clause that the material lead time could influence the substantial and final completion dates?
 1. Yes, completion dates will be updated based upon lead times of materials. After award and prior to the pre-construction conference, the Contractor will be required to submit a CPM schedule in accordance with the Contract Documents for Owner review and approval. The adjusted completion dates will be based upon the approved CPM schedule.
 2. Placement of asphalt Concrete may occur past the 15 September date as long as the limitations outlined in subsection 401-3.03 are followed.

6. What grade of Oil would the owner like utilized in the HMA IIA item? Currently using PG58-34?
 - a. The minimum grade required for the bid is PG52-28. If a contractor uses something other that will be their choice and there won't be preference given for a higher quality. PG58-34 oil is acceptable for use as the asphaltic binder. Substitutions may be made prior to the placement of asphalt concrete as one oil grade shall be used throughout the entirety of the project. All binder must meet the requirements of subsection 702-2.01 and be specified in the approved job mix design per subsection 401-2.09.

Please replace Appendix I; Cost Schedule in its entirety with the one attached below

The following items have been added:

BASE BID ITEMS:

Item No. 5.1.2 (603.0023.2) – 18”Ø Corrugated Metal Pipe (CMP), 10ga., aluminized steel

Provide all equipment, labor, and materials to construct culverts, to the lines and grades shown on the Plans, and in accordance with Section 603 “*CULVERTS AND STORM DRAINS*”. Culvert material shall be 24”Ø corrugated pipe with an aluminized steel coating constructed from steel with a minimum thickness of 10 gauge. Excavation, bedding, and backfill are subsidiary to this work and must conform to the requirements set forth in subsections 204-2.01 and 204-3.01, and the details on the plans. Join sections of CMP in accordance with subsection 303-3.03.2 “*Metal Pipe*”.

The accepted quantity will be paid for at the agreed upon linear foot unit price as measured in place per subsection 603-4.01.2 “*Pipes for Storm Drains*” and in accordance with Section 109, Section 603, and Supplemental Condition SC-01.

Item No. 5.1.3 (603.0023.3) – 12”Ø Corrugated Metal Pipe (CMP), 10ga., aluminized steel

Provide all equipment, labor, and materials to construct culverts, to the lines and grades shown on the Plans, and in accordance with Section 603 “*CULVERTS AND STORM DRAINS*”. Culvert material shall be 24”Ø corrugated pipe with an aluminized steel coating constructed from steel with a minimum thickness of 10 gauge. Excavation, bedding, and backfill are subsidiary to this work and must conform to the requirements set forth in subsections 204-2.01 and 204-3.01, and the details on the plans. Join sections of CMP in accordance with subsection 303-3.03.2 “*Metal Pipe*”.

The accepted quantity will be paid for at the agreed upon linear foot unit price as measured in place per subsection 603-4.01.2 “*Pipes for Storm Drains*” and in accordance with Section 109, Section 603, and Supplemental Condition SC-01.

All other terms and conditions remain unchanged.
If there are any questions regarding this addendum please let me know.

Thank you,

Greg C Goemer
Sr. Contract Administrator
Alaska Railroad Corporation

REVISION: 11/14 DISTANCE FROM RUNG TO TOP OF CONE NOW 8"; 1/15 ADDED MAX DIST INFO TO NOTE 4

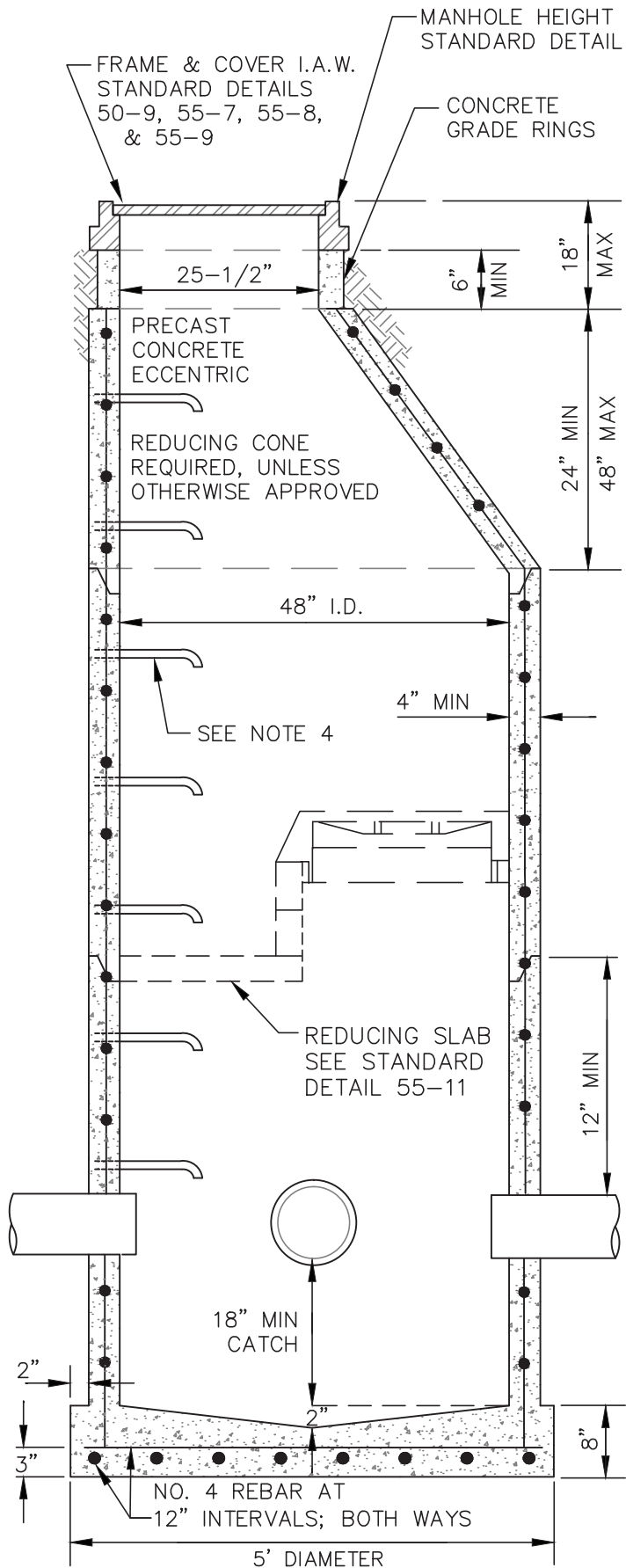

NOTES:

1. MANHOLE SECTIONS SHALL CONFORM TO A.S.T.M. C-478.
2. EXTEND PIPE 2" INTO MANHOLE. SEAL PIPE PENETRATIONS WITH NON-SHRINKABLE GROUT MIXED WITH POTABLE WATER I.A.W. MANUFACTURERS RECOMMENDATIONS.
3. BLOCKOUTS SHALL BE FORMED.
4. PLACE RUNGS 12" ON-CENTER ON UNOBSTRUCTED SIDE OF MANHOLE 18" MAX. FROM BOTTOM OF MANHOLE & 8" MAX. FROM TOP OF CONE. IF UNOBSTRUCTED SIDE NOT AVAILABLE, BOTTOM RUNG TO BE PLACED 6" OVER SMALLEST PIPE. WHEN USING REDUCING CONE, MAXIMUM DEPTH TO FIRST LADDER RUNG IS 24". WHEN USING FLAT SINGLE ACCESS LIDS, THE MAXIMUM DEPTH TO THE FIRST LADDER RUNG IS 28". SEE MANHOLE STEP STANDARD DETAIL 50-6.
5. MANHOLE SHALL HAVE MINIMUM OF ONE 6" GRADE RING.
6. BACKFILL AROUND MANHOLE WITH A MINIMUM OF 3' TYPE II CLASSIFIED FILL & BACKFILL. BACKFILL SHALL BE INCIDENTAL TO COST OF MANHOLE INSTALLATION.
7. CATCH BASIN LEADS SHALL ENTER THE MANHOLE AT LEAST ONE PRIMARY LEAD DIAMETER ABOVE THE TOP OF THE PRIMARY LEAD UNLESS MINIMUM PIPE SLOPES CANNOT BE ACHIEVED.
8. STEEL REQ'D FOR BARREL SHALL CONFORM TO A.S.T.M. C-478. EMBED STEEL IN BASE SO THAT FIRST BARREL SECTION IS CONNECTED WITH BASE.
9. "RAM-NEK" OR EQUAL AND PRIME BARREL JOINTS. HEAT "RAM-NEK" AND SEAL SURFACES BEFORE FINAL ASSEMBLY.
10. PRIMARY LEADS NOT TO EXCEED 24" CPEP OR HDPEP WITH INCLUDED ANGLE BETWEEN LEADS GREATER THAN OR EQUAL TO 135°, OR PRIMARY LEADS NOT TO EXCEED 18" CPEP OR HDPEP WITH INCLUDED ANGLE LESS THAN 135°.
11. A TYPE I MANHOLE SHALL NOT BE USED WHEN BOTH CATCH BASIN AND ACCESS FUNCTIONS ARE REQUIRED.

MUNICIPALITY



OF ANCHORAGE

SCALE:
NTS

APPROVED:

REVISED:
1/15

**STORM DRAIN MANHOLE
TYPE I
PIPE ≤ 24"**

SECTION #
55.05

DETAIL #
55-4

REVISION: 1/15 MODIFIED PICKHOLE REQUIREMENT, ADDED ADDITIONAL VENT NOTE

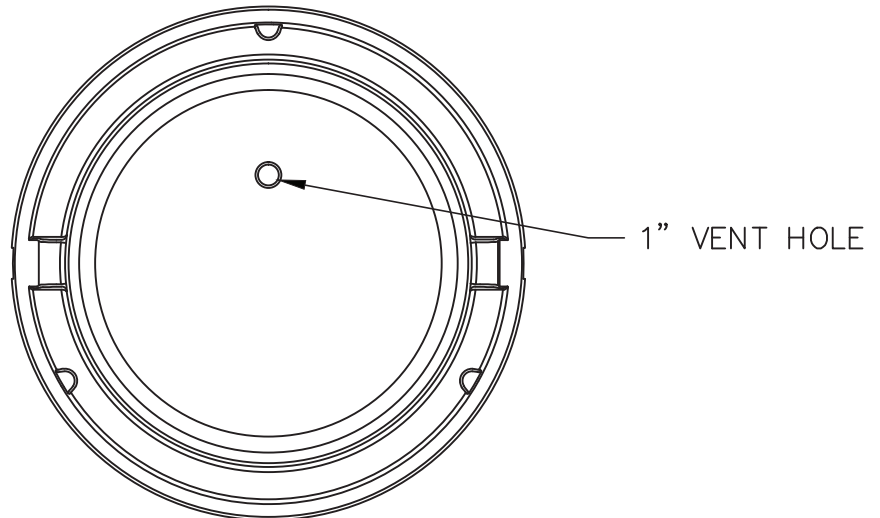
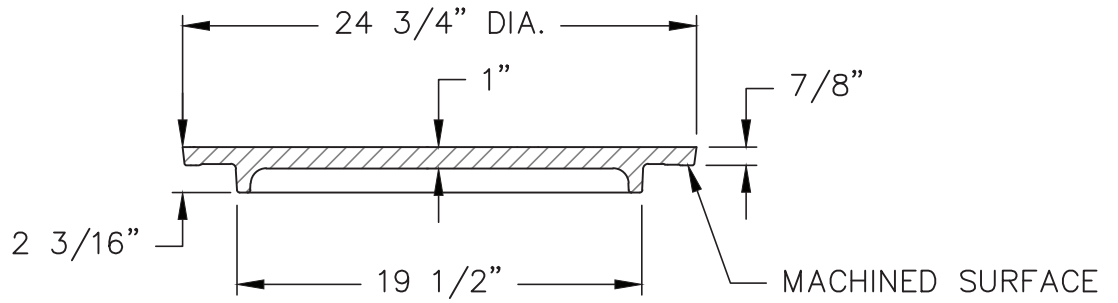
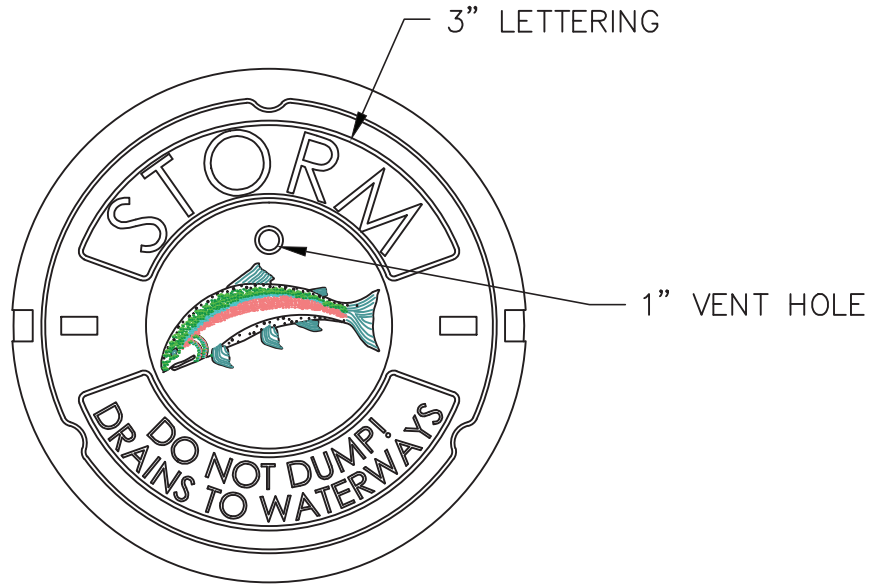

STORM DRAIN COVERS SHALL HAVE TWO (2) CLOSED PICKHOLES, ONE ON EACH SIDE OF THE COVER.

MUNICIPALITY



OF ANCHORAGE

SCALE:
NTS

APPROVED:

REVISED:
1/15

STORM DRAIN MANHOLE COVER

SECTION #
55.05

DETAIL #
55-7

APPENDIX I – Cost Schedule

COST SCHEDULE: A Bidder's Failure to provide the information requested in this Appendix may be cause for rejection of the bid on the basis on non-responsiveness. Cost shall be bid in accordance to all specifications in Appendix C, and any Technical Specifications incorporated herein.

AWARD CRITERIA: A contract award resulting from this solicitation may be made to the low, responsive, responsible bidder who meets the requirements as set forth in the plans and specifications and compliance thereof. An award may be made in the aggregate of Base Bid and or any combination of Base Bid and Add Alternates, whichever is deemed by the Contract Administrator to be in the best interest of the ARRC. The successful bidder shall hold unit prices of all additives firm for a period of thirty (30) days from the date of bid opening. Award is contingent on the availability of ARRC funds

BASE BID ITEMS					
Item No.	Item Description	Unit	Quantity ³	Unit Bid Price	Amount Bid
1	Mobilization	Lump Sum	1		
2.1	Procure, 48"Ø Precast Manhole	Each	1		
2.2	Procure, 90"Ø Precast Manhole	Each	13		
3.1	Removal of Manhole	Each	13		
3.2	Removal of Culvert Pipe	Lump Sum	1		
4.1	Install, Precast 48"Ø Precast Manhole	Each	1		
4.2	Install, Precast 90"Ø Precast Manhole	Each	13		
5.1.1	24"Ø CMP, 10ga., Aluminized Steel	Linear Foot	1,260		
5.1.2	18"Ø CMP, 10ga., Aluminized Steel	Linear Foot	460		
5.1.3	12"Ø CMP, 10ga., Aluminized Steel	Linear Foot	200		
5.2	24"Ø x 0.750"t Steel Pipe	Lump Sum	1		
6	Repair Existing 72"Ø Steel Pipe	Lump Sum	1		
7	Construction Surveying	Lump Sum	1		

Total Base Bid :

ADDITIVE ALTERNATE BID ITEMS ¹

Item No.	Item Description	Unit	Quantity ³	Unit Bid Price	Amount Bid
A1	Unclassified Excavation	Cubic Yard	810		
A2	Aggregate Base Course, Grading D-1	Ton ⁴	100		
A3	Hot Mix Asphalt, Type II: Class A	Ton	4,840		

Notes:

¹ Award of Additive Alternate Bid items is dependent on Owner finances. The successful bidder will be notified of the Owner's intent to award additional work prior to receiving a Contract or Notice to Proceed (NTP).

³ Bid quantities are approximate. Contractor is responsible for their own quantity take-offs using the information within the Contract Documents to verify the quantities in the Cost Schedule.

⁴ Aggregate Base Course, Grading D-1 will only be utilized if the unclassified excavation material cannot be classified or if additional fill material is required.

NON-COLLUSION AFFIDAVIT: The Undersigned declares, under penalty of perjury under the laws of the United States, that neither he/she nor the firm, association, or corporation of which he/she is a member, has, either directly or indirectly, entered into any agreement, participated in any collusion, or otherwise taken any action in restraint of free competitive bidding in connection with this Bid.

The Undersigned has read the foregoing proposal and hereby agrees to the conditions stated therein by affixing his/her signature below:

BIDDERS NAME AND ADDRESS

COMPANY NAME

SIGNATURE BY AND FOR THE BIDDER

COMPANY MAILING ADDRESS

PRINTED NAME OF ABOVE BIDDER

CITY, STATE ZIP CODE

DATE OF BID

CONTACT PHONE NUMBER

CONTACT E-MAIL