

750C-Half.ctb
P:\Engineering\Motive Power and Equipment\2. Passenger Equipment Rehab\2024 Projects\DHI CoachB-End Subfloor Replacement\DHI Coach B-End Subfloor Replacement.dwg

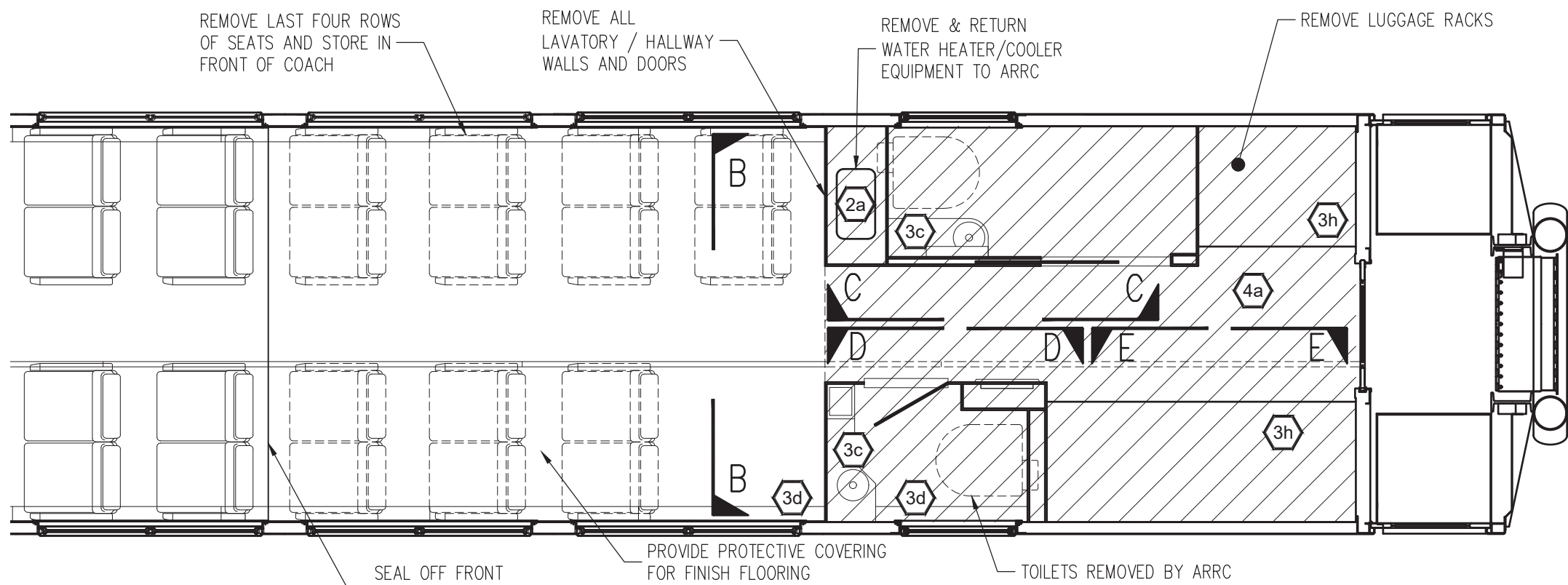

A
1
DISASSEMBLY & DEMO
SCALE: 3/16" = 1'-0"

AREA OF SUBFLOOR REPLACEMENT: APPROX. 120 FT²

- DEMOLITION NOTES:**
- CONTRACTOR SHALL PERFORM PRE-DEMOLITION WALK THROUGH WITH OWNER'S REPRESENTATIVE TO FIELD VERIFY, CONFIRM AND MARK ALL MATERIALS, SYSTEMS AND EQUIPMENT TO BE REMOVED PRIOR TO BEGINNING DEMOLITION WORK. ANY ITEMS DESIGNATED FOR SALVAGE SHALL BE DELIVERED TO ARRC.
 - DISASSEMBLE AND RETURN EXISTING EQUIPMENT TO ARRC:
 - WATER COOLER LOCKER EQUIPMENT
 - WATER COOLER
 - WATER HEATER
 - DISASSEMBLE AND RETAIN FOR REINSTALLATION:
 - LAST FOUR ROWS OF SEATS TO CREATE WORKING AREA IN COACH
 - PA SYSTEM
 - LAVATORY CABINETS, FIXTURES & EQUIPMENT
 - BASEBOARD HEATER COVERS
 - WALL MOUNTED LIGHT FIXTURES
 - EMERGENCY TOOLS
 - FIRE EXTINGUISHER
 - LUGGAGE RACKS
 - WALL MOUNTED ARTWORK AND PHOTOGRAPHS
 - BULKHEADS, LAVATORY WALLS, DOORS, HARDWARE AND TRIM.
 - WATER COOLER / TRASH LOCKER, DOORS AND HARDWARE.
 - DISASSEMBLE THE MINIMAL AMOUNT OF WATER SUPPLY AND DRAIN LINES NECESSARY TO FACILITATE COMPLETE LAVATORY DISASSEMBLY.
 - DEMOLISH AND DISCARD:
 - HALLWAY AND LAVATORY AREA FLOORING AND SUBFLOOR
 - UNDERFLOOR INSULATION UNDER AREA OF SUBFLOOR REPLACEMENT.
 - UNDERFLOOR SPARK GUARDS WHERE CORRODED OR DECAYED.



VIEW B-B



VIEW C-C

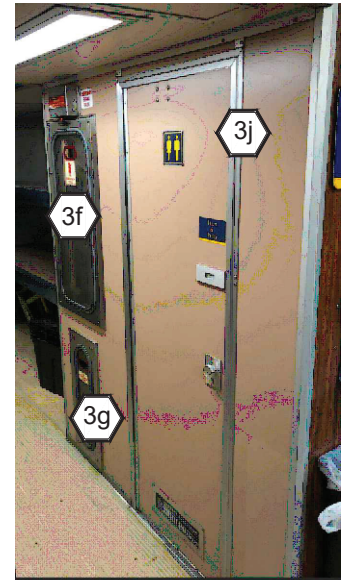

VIEW D-D

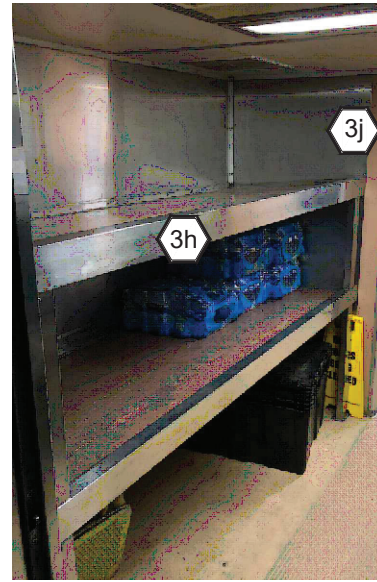

VIEW E-E

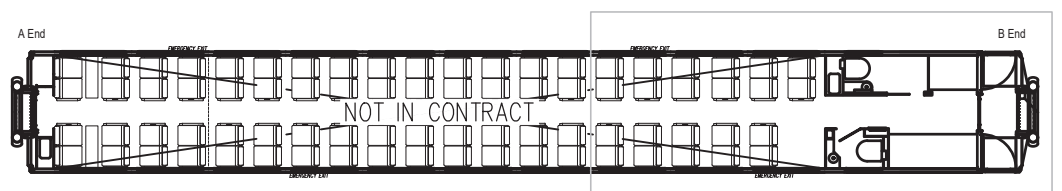

KEY PLAN

DETAIL A1

REV.	DATE	BY	REVISION

ALASKA RAILROAD CORPORATION ENGINEERING SERVICES P.O. BOX 107500, ANCHORAGE, ALASKA 99510-7500		
PROJECT : MOTIVE POWER AND EQUIPMENT PASSENGER EQUIPMENT		
TITLE: DHI COACH B-END SUBFLOOR REPLACE DISASSEMBLY PLAN		
DESIGNED BY: ARRC	SCALE : NTS	AFE NO.: 11194 FTA
DRAWN BY: ARRC	DATE : SEPTEMBER 2024	ACAD FILE:
CHECKED BY: ARRC		DWG NO.
APPROVED BY: ARRC		1 OF 3

750C-Half.ctb
P:\Engineering\Motive Power and Equipment\2. Passenger\Passenger Equipment Rehab\2024
Projects\DHI CoachB-End Subfloor Replacement\DHI Coach B-End Subfloor Replacement.dwg

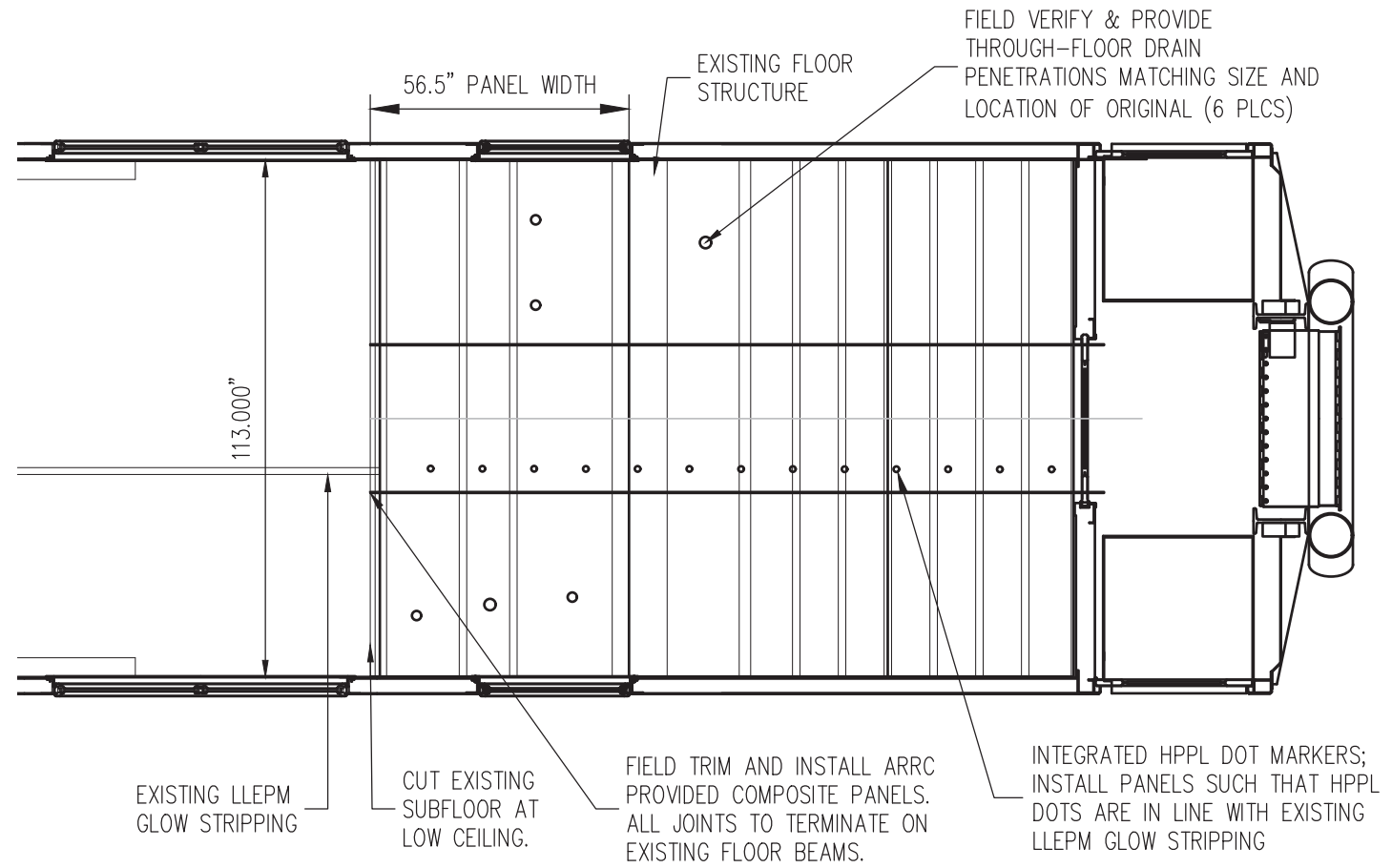

A PLAN VIEW
2 SCALE: 3/16" = 1'-0"

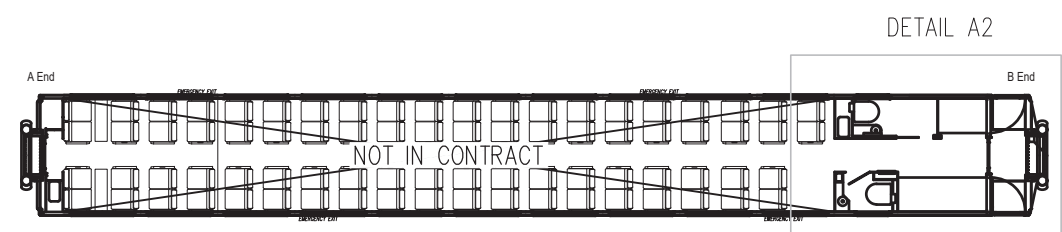

KEY PLAN

- NOTES:
1. DEMOLISH AND DISCARD:
 - 1.a. HALLWAY AND LAVATORY AREA FLOORING AND SUBFLOOR AS SHOWN IN DRAWING.
 - 1.a.a. PROVIDE 3/4" PLYWOOD TEMPORARY SUBFLOOR FOR WORKING SURFACE AS NEEDED.
 - 1.b. UNDERFLOOR INSULATION BELOW AREA OF SUBFLOOR REPLACEMENT.
 - 1.c. UNDERFLOOR SPARK GUARDS WHERE CORRODED OR DECAYED.
 2. REMOVE CORROSION AND SCALE FROM FLOOR STRUCTURE. COAT WITH RUST INHIBITING PRIMER.
 3. PROVIDE AND INSTALL:
 - 3.a. NEW 20 GA ASTM A606 SPARK GUARDS WHERE MISSING OR DAMAGED.
 - 3.b. NEW UNDERFLOOR FIBERGLASS INSULATION BATTING MATCHING ORIGINAL THICKNESS.
 - 3.c. COMPOSITE SUBFLOOR PANELS (ARRC PROVIDED)
 - 3.c.a. COAT ANY AREA OF BARE METAL FLOOR JOIST EXPOSED FROM DEMOLITION WITH RUST INHIBITING COATING PRIOR TO SUBFLOOR INSTALLATION.
 - 3.c.b. INSTALL COMPOSITE SUBFLOOR IN ACCORDANCE WITH THE MANUFACTURERS INSTRUCTIONS. COMPOSITE PANELS TO BE LEVELED AND BONDED TO EXISTING SUBSTRUCTURE.
 - 3.c.c. TRIM SUBFLOOR PANELS TO FIT AS REQUIRED. PANELS MAY BE CUT WITH STANDARD WOODWORKING TOOLS FITTED WITH DIAMOND TIPPED BLADES.

ALASKA RAILROAD CORPORATION ENGINEERING SERVICES P.O. BOX 107500, ANCHORAGE, ALASKA 99510-7500		
PROJECT : MOTIVE POWER AND EQUIPMENT PASSENGER EQUIPMENT		
TITLE : DHI COACH B-END SUBFLOOR REPLACE SUBFLOOR INSTALLATION		
DESIGNED BY: ARRC	SCALE : NTS	AFE NO.: 11194 FTA
DRAWN BY: ARRC	DATE : SEPTEMBER 2024	ACAD FILE: DWG NO.
CHECKED BY: ARRC		2 OF 3
APPROVED BY: ARRC		

750C-Half.ctb P:\Engineering\Motive Power and Equipment\2. Passenger\Passenger Equipment Rehab\2024 Projects\DHI CoachB-End Subfloor Replacement\DHI Coach B-End Subfloor Replacement.dwg

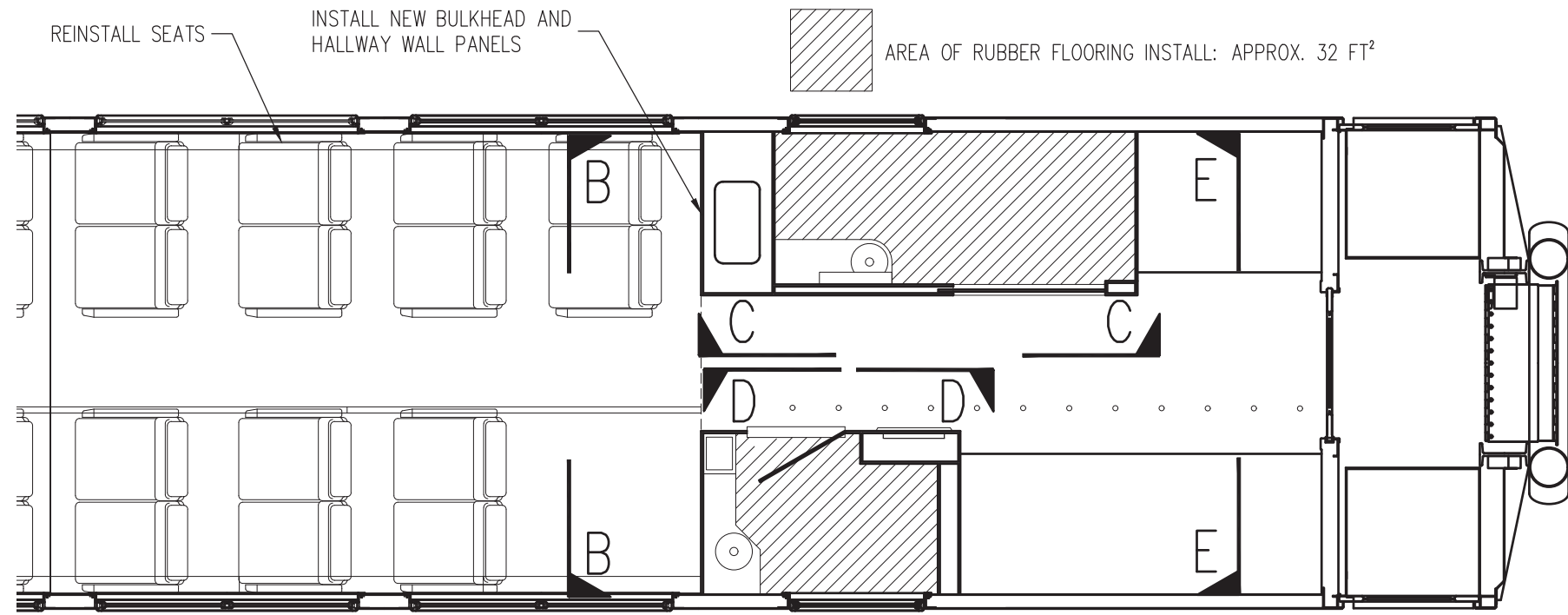

INSTALLATION NOTES:

1. PROVIDE AND INSTALL:
 - 1.a. NEW 1/2" APA B-B, GROUP 1, EXTERIOR, SANDED PLYWOOD LAMINATED WITH WF-1 HPL TO REPLACE HALLWAY WALLS, LAVATORY DOORS AND BULKHEADS AS SHOWN IN VIEW B-B THROUGH E-E. LAVATORY INTERIOR WALL PANELS TO BE REUSED UNLESS SHOWING SIGNS OF DELAMINATION OR DECAY.
 - 1.a.a. WF-1: FORMICA 932-58 'ANTIQUE WHITE', MATTE FINISH, OR APPROVED EQUAL. BACK SIDE OF PANEL LAMINATED WITH GENERIC STANDARD COLOR HPL.
 - 1.a.b. EXISTING DOOR HARDWARE TO BE REINSTALLED ON NEW DOORS.
 - 1.a.c. EXISTING MOLDINGS AND FIXTURES TO BE REINSTALLED AFTER PANEL REPLACEMENT.
 - 1.b. CLEAR-ANODIZED 6063 EXTRUDED ALUMINUM TRIM TO REPLACE DAMAGED ORIGINAL TRIM AS REQUIRED:
 - 1.b.a. 1/8" x 1-1/2" FLAT BAR
 - 1.b.b. 1/8" x 1-1/2" ANGLE
2. REINSTALL (EXISTING OR NEW ARRC PROVIDED):
 - 2.a. ALL REMOVED EQUIPMENT WITH EXCEPTION TO:
 - 2.a.a. WATER COOLER EQUIPMENT
 - 2.a.b. WATER HEATERS
 - 2.b. LAVATORY CABINETS, COUNTER TOPS AND FAUCETS.
 - 2.c. ALL UTILITIES DISTURBED BY THIS WORK.
 - 2.d. NEW ARRC PROVIDED ON-DEMAND LAVATORY HOT WATER HEATERS.
 - 2.e. ARRC PROVIDED STAINLESS STEEL LAVATORY FLOOR PANS.
 - 2.f. ARRC PROVIDED INDUSTRIAL RUBBER FLOORING IN LAVATORY.
 - 2.g. SEATS INTO ORIGINAL LOCATIONS.

A
1
DISASSEMBLY & DEMO
SCALE: 3/16" = 1'-0"

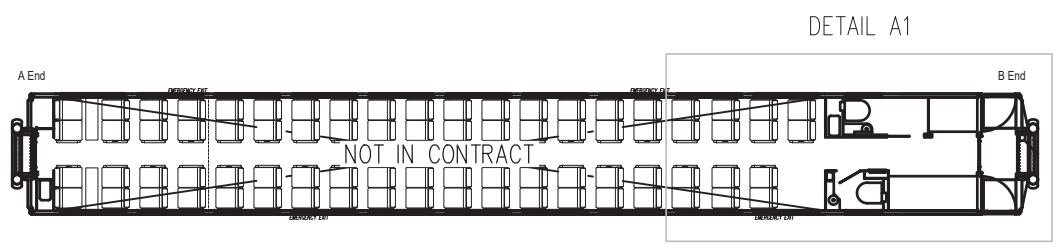
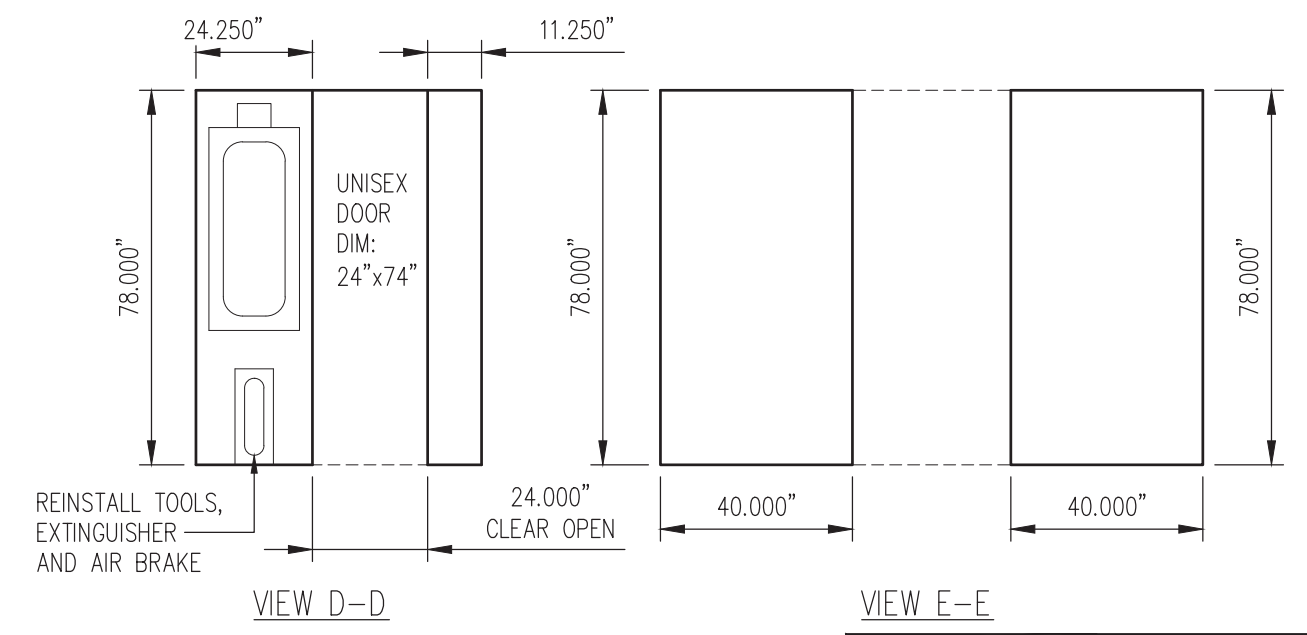
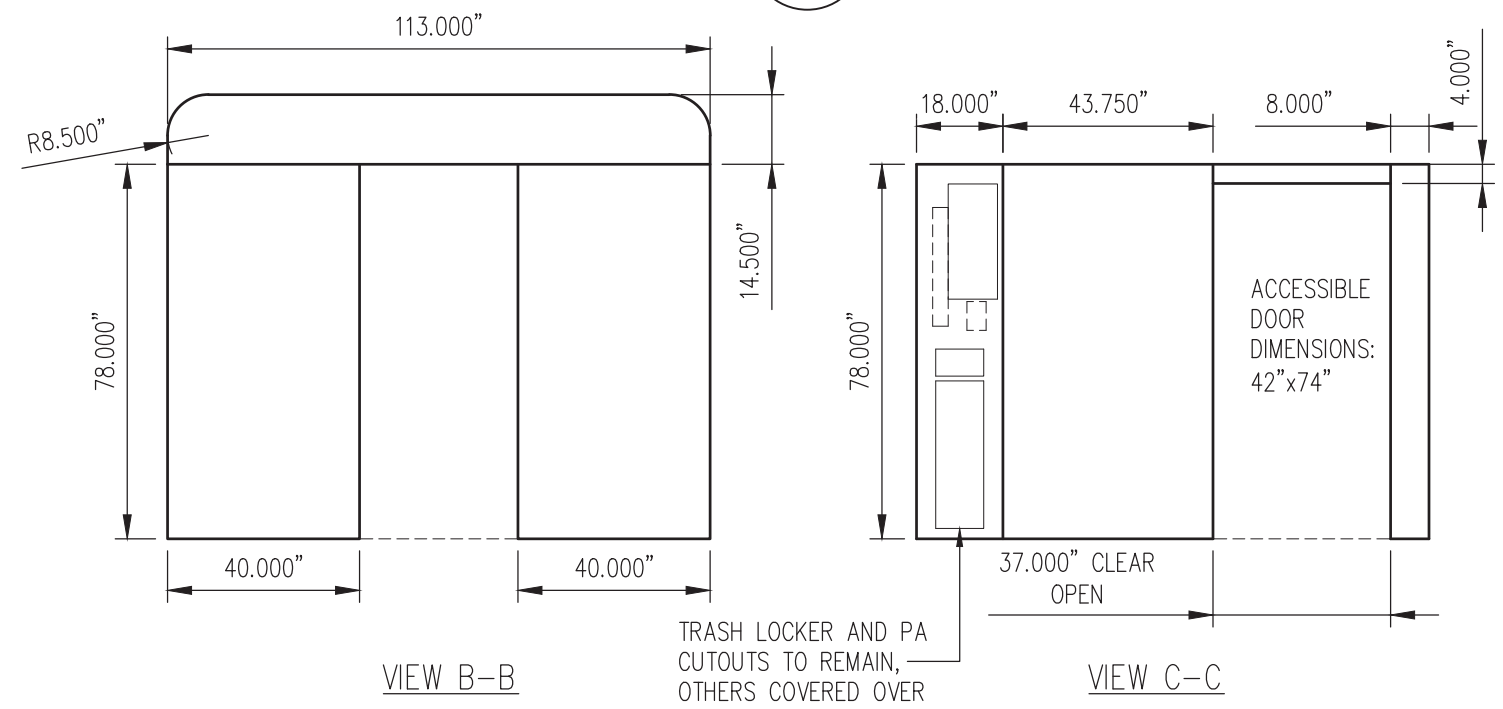

KEY PLAN

REV.	DATE	BY	REVISION

ALASKA RAILROAD CORPORATION ENGINEERING SERVICES P.O. BOX 107500, ANCHORAGE, ALASKA 99510-7500		
PROJECT : MOTIVE POWER AND EQUIPMENT PASSENGER EQUIPMENT		
TITLE : DHI COACH B-END SUBFLOOR REPLACE REINSTALLATION PLAN		
DESIGNED BY: ARRC DRAWN BY: ARRC CHECKED BY: ARRC APPROVED BY: ARRC	SCALE : NTS DATE : SEPTEMBER 2024	AFE NO.: 11194 FTA ACAD FILE: DWG NO. 3 OF 3