

DRAWING LOCATION: P:\PROJECTS\01 PROJECTS\03 DOCKS AND SLIPS\WHITTIER\WHITTIER MARINE TERMINAL\REPAIRS\2024 DREDGING\WHITTIER DREDGING 2024 FIGURES.DWG  
 DATE: 11/12/2024 11:30 AM  
 SCALE: AS NOTED  
 PUBLISHED CTB: -----

# ALASKA RAILROAD CORPORATION

## ENGINEERING SERVICES

P.O. BOX 107500, ANCHORAGE, ALASKA 99510-7500

DESIGNED BY:	ARRC
CHECKED BY:	ARRC
DRAFTED BY:	ARRC

ALASKA RAILROAD CORPORATION  
 PO BOX 107500, ANCHORAGE, AK  
 99510-7500  
 327 W SHIP CREEK AVE  
 ANCHORAGE, AK 99501  
 (907) 265-2300

KEY MAP

## WHITTIER BARGE BASIN DREDGING 2024

### XX% PLANS

NOVEMBER 2024

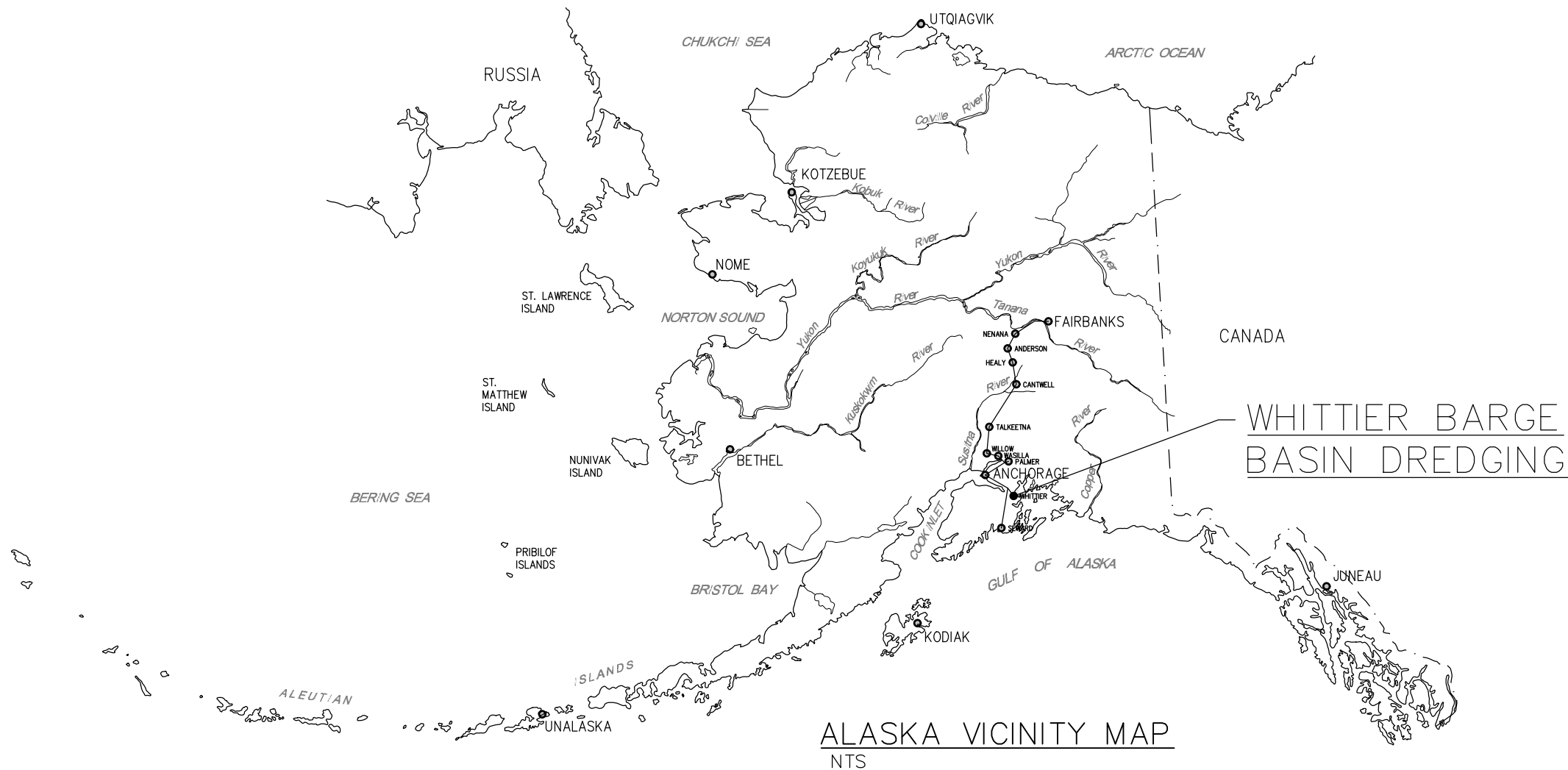

ALASKA VICINITY MAP  
NTS

A/E FIRM

ENGINEERING DEPARTMENT  
 P.O. BOX 107500  
 ANCHORAGE, ALASKA 99510-7500



PROJECT: WHITTIER BARGE BASIN DREDGING

SHEET TITLE: TITLE PAGE

AFE NO.	XXX
YEAR	2024
SHEET	1 OF 4

P:\PROJECTS\01\_PROJECTS\03 DOCKS AND SLIPS\WHITTIER\WHITTIER MARINE TERMINAL REPAIRS\2024 DREDGING\WHITTIER DREDGING 2024 FIGURES.DWG  
 PUBLISHED CTB  
 SCALE AS NOTED  
 DATE 11/12/2024 11:30 AM  
 TIME  
 DRAWING LOCATION

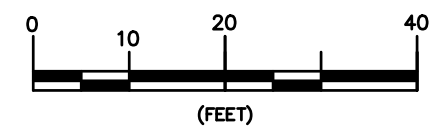
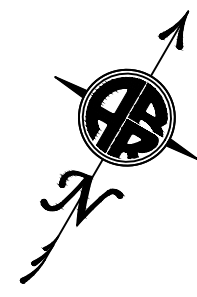
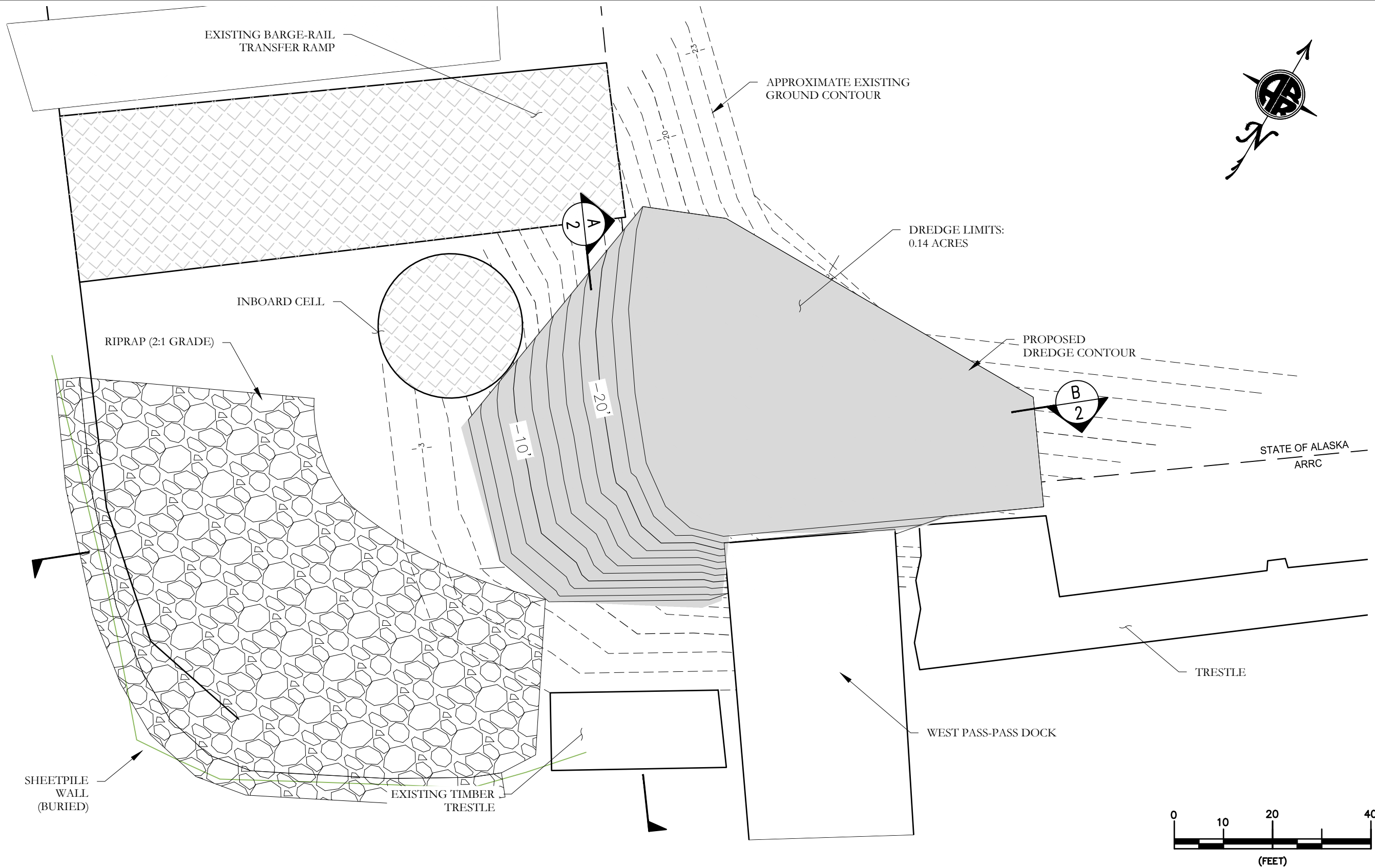

**PURPOSE:**  
TO RE-ESTABLISH DEPTH OF EXISTING BARGE BERTHING BASIN TO ALLOW CONTINUED OPERATIONS

- NOTES:**
1. NO FEDERAL PROJECTS, WETLANDS, OR NAVIGATION CHANNEL WITHIN 200' OF THIS PROPOSED ACTIVITY.
  2. LAND USE ZONE IS INDUSTRIAL
  3. TOTAL DREDGE VOLUME IS APPROX. 1000 CY.
  4. DREDGE CONTOURS TO BE FIELD FIT, WITH APPROVAL FROM OWNER'S REPRESENTATIVE.

DATUM: MEAN LOWER LOW WATER = 0'0"

ADJACENT PROPERTY OWNERS:  
 UPLANDS: ALASKA RAILROAD CORPORATION  
 OFFSHORE: STATE OF ALASKA, LEASED TO ALASKA RAILROAD CORPORATION

**CONTOUR/SURVEY DATA**  
 APPROXIMATE EXISTING GROUND CONTOUR IS BASED ON 2021 R&M BATHYMETRIC SURVEY. CLOSER SHORELINE CONTOURS ARE ESTIMATION FROM LOCALIZED KNOWLEDGE  
 ELEVATIONS ARE CONTROLLED SURVEY POINTS IN TABLE.

	NORTHING	EASTING	ELEVATION	DESCRIPTION
CP 100	2478222.89	1877049.70	17.79	SET REBAR W/ YPC
CP 373	2478227.01	1874051.34	22.78	NOAA BC, 4949D 2007

DESIGNED BY:	ARRC
CHECKED BY:	ARRC
DRAFTED BY:	ARRC
ALASKA RAILROAD CORPORATION PO BOX 107500, ANCHORAGE, AK 99510-7500 327 W SHIP CREEK AVE ANCHORAGE, AK 99501 (907) 265-2300	
KEY MAP	
A/E FIRM	
ENGINEERING DEPARTMENT	P.O. BOX 107500 ANCHORAGE, ALASKA 99510-7500
PROJECT: WHITTIER BARGE BASIN DREDGING	
SHEET TITLE: DREDGING LIMITS	
AFE NO.	XXX
YEAR	2024
SHEET	2 OF 4

Elevation

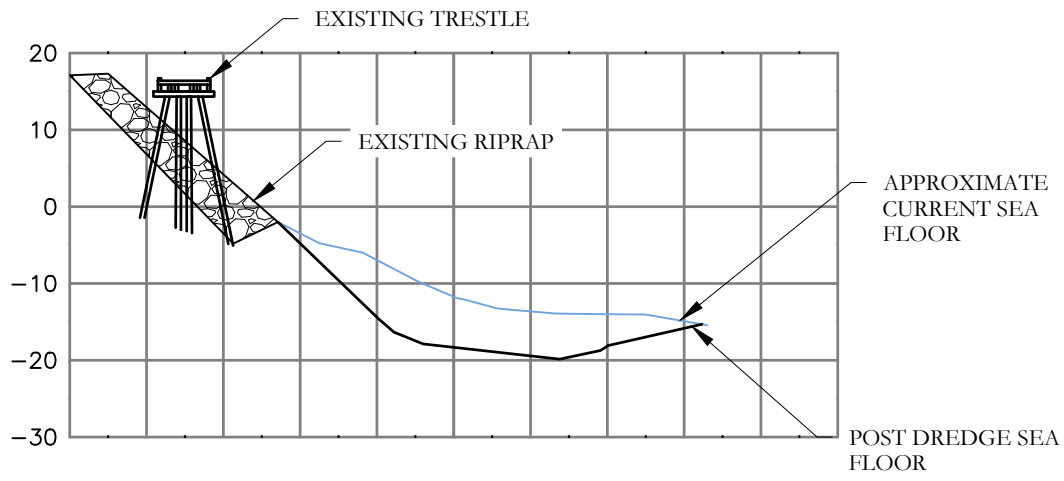

A  
02 DREDGE CROSS SECTION  
2:1 VERTICAL EXAGGERATION

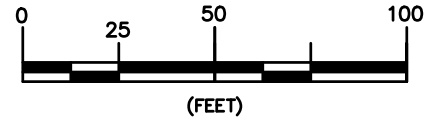

Elevation

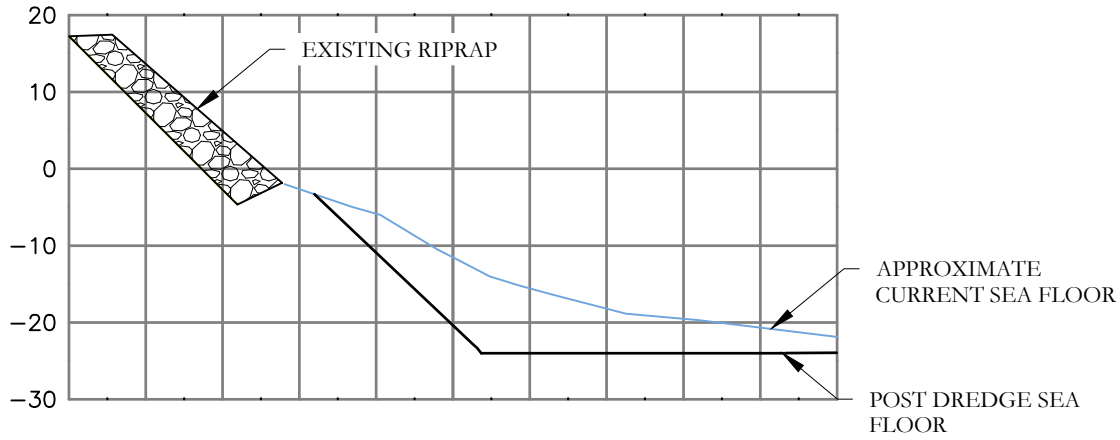

B  
02 DREDGE CROSS SECTION  
2:1 VERTICAL EXAGGERATION

DESIGNED BY:	ARRC
CHECKED BY:	ARRC
DRAFTED BY:	ARRC

ALASKA RAILROAD CORPORATION  
PO BOX 107500, ANCHORAGE, AK  
99510-7500  
327 W SHIP CREEK AVE  
ANCHORAGE, AK 99501  
(907) 265-2300

KEY MAP

A/E FIRM

ENGINEERING DEPARTMENT  
P.O. BOX 107500  
ANCHORAGE, ALASKA 99510-7500



PROJECT: WHITTIER BARGE BASIN DREDGING

SHEET TITLE: SECTION VIEW

AFE NO. XXX

YEAR 2024

SHEET 3 OF 4

P:\PROJECTS\01 PROJECTS\03 DOCKS AND SLIPS\WHITTIER\WHITTIER MARINE TERMINAL\REPAIRS\2024 DREDGING\WHITTIER DREDGING 2024 FIGURES.DWG  
 DRAWING LOCATION  
 PUBLISHED CTB  
 11/12/2024 11:30 AM  
 SCALE AS NOTED  
 DATE TIME  
 AS NOTED



**NOTES:**

1. ACCESS TO THE DUMPSITE WILL LIKELY NEED SOME SITE PREPARATION DUE TO SNOW ACCUMULATION AND STEEPNESS OF APPROACH UP THE HILLSIDE..

ADJACENT PROPERTY OWNERS:  
 UPLANDS: ALASKA RAILROAD CORPORATION  
 OFFSHORE: STATE OF ALASKA, LEASED TO ALASKA RAILROAD CORPORATION

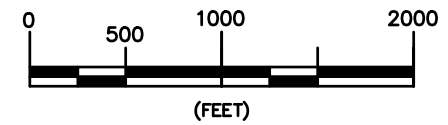

DESIGNED BY:	ARRC
CHECKED BY:	ARRC
DRAFTED BY:	ARRC

ALASKA RAILROAD CORPORATION  
 PO BOX 107500, ANCHORAGE, AK  
 99510-7500  
 327 W SHIP CREEK AVE  
 ANCHORAGE, AK 99501  
 (907) 265-2300

KEY MAP

A/E FIRM

ENGINEERING DEPARTMENT  
 P.O. BOX 107500  
 ANCHORAGE, ALASKA 99510-7500



PROJECT: WHITTIER BARGE BASIN DREDGING

SHEET TITLE: MATERIAL HAUL ROUTE

AFE NO. XXX

YEAR 2024

SHEET 4 OF 4